

WARNING: READ THE ASSEMBLING INSTRUCTIONS CAREFULLY BEFORE ASSEMBLING THE IN-GROUND BENCH SEAT WITH BACK REST.



Make sure to wear protective gloves and foot protection when installing and assembling this product. Unpack the unit and make sure all the components are included before proceeding. This activity requires two or more people as lifting is involved. Please ensure bolts are only finger-tightened during the assembling process for flexibility in lining up components. Securely tighten the bolts before anchoring the product to the ground.



**4m. IN-GROUND BENCH SEAT WITH BACK REST
(CODE No. FELIGB4)**

ITEM PART	DESCRIPTION	QTY
IGBR1	SEAT FRAME	3
IGBR2	4000 mm.— ALUMINIUM SEAT PLANK	1
IGBR3	4000 mm.—ALUMINIUM BACK REST	1
IGBR4	M6 x25mm. HEXAGONAL HEAD BOLT	18
IGBR5	M6 LOCKNUT	18

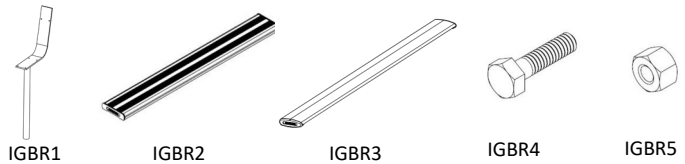

Thank you for purchasing our high quality products. The In-ground Bench Seat with Back Rest has been well manufactured with certified materials, to achieve high reliability and minimum maintenance. It is our commitment to provide you cost-effective solutions for outdoor applications.



1

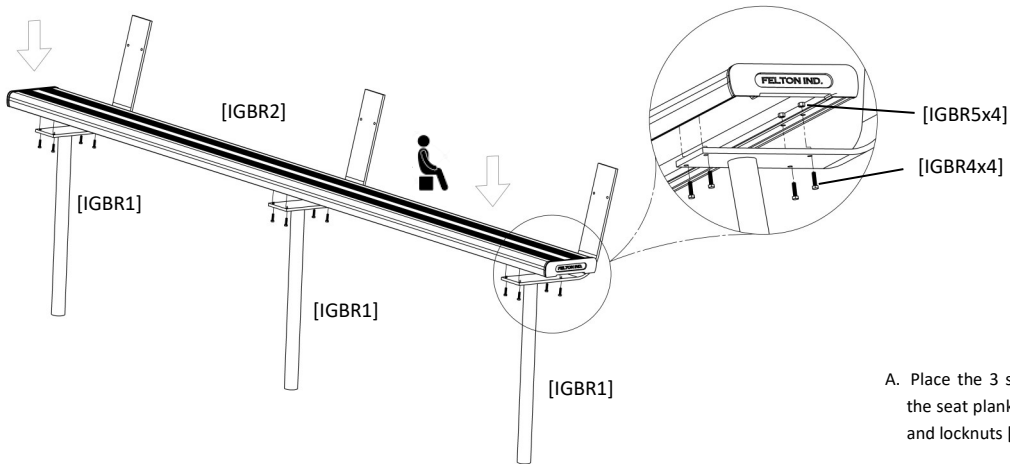

A. Place the 3 seat frames **[IGBR1]** and attach them to the seat plank **[IGBR2]**, by using hexagonal bolts **[IGBR4]** and locknuts **[IGB5]** — finger tighten.



2

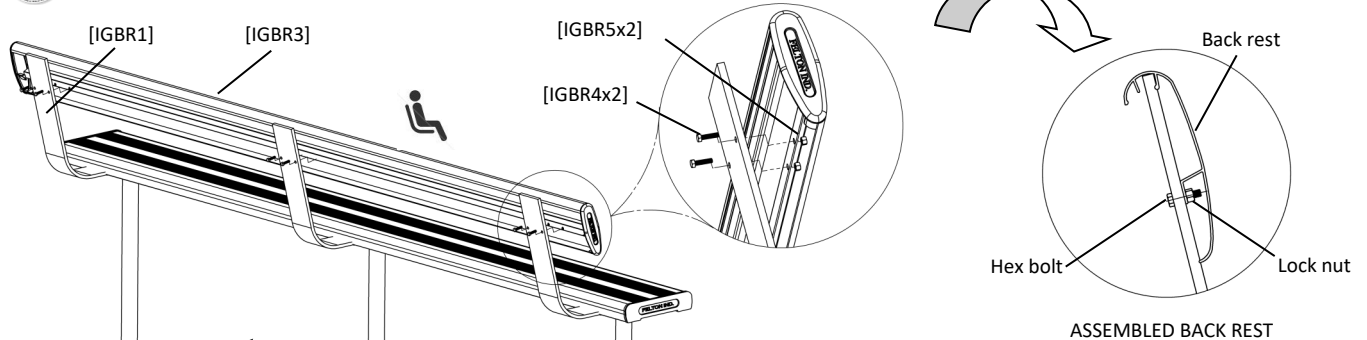

A. Attach the back rest plank **[IGBR3]** to the top of the seat frame plate **[IGBR1]**, by using hexagonal bolts **[IGBR4]** and lock nuts **[IGBR5]**, as illustrated - finger tighten.

B. Tight all fasteners with spans, wrench and /or a proper tool.

P1

WARNING: READ THE ASSEMBLING INSTRUCTIONS CAREFULLY BEFORE ASSEMBLING THE IN-GROUND BENCH SEAT WITH BACK REST.



Make sure to wear protective gloves and foot protection when installing and assembling this product. Unpack the unit and make sure all the components are included before proceeding. This activity requires two or more people as lifting is involved. Please ensure bolts are only finger-tightened during the assembling process for flexibility in lining up components. Securely tighten the bolts before anchoring the product to the ground.



3

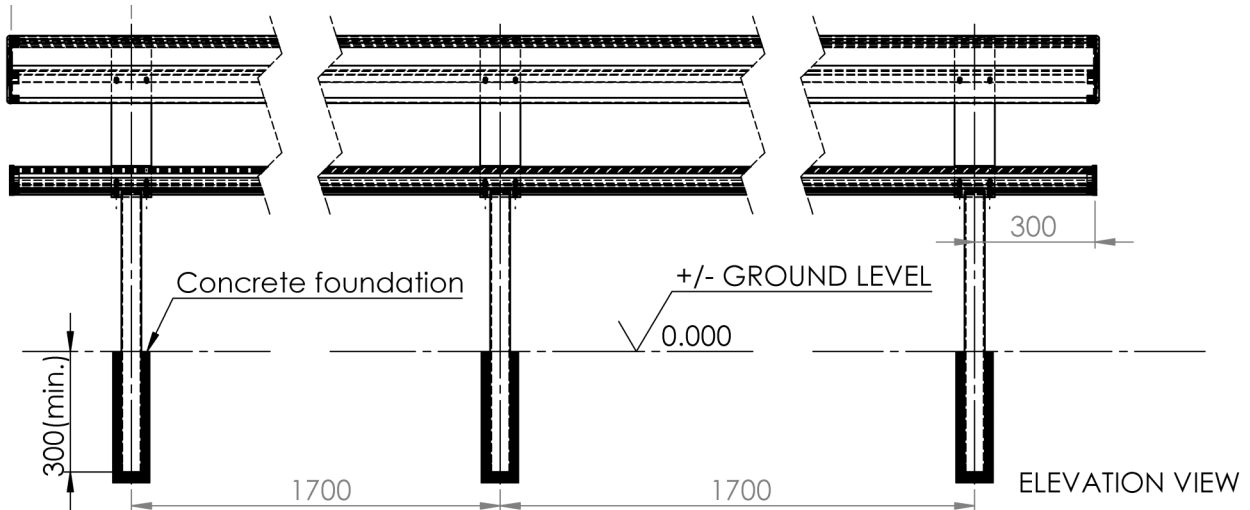

GENERAL INSTALLATION RECOMMENDATIONS:

- A. Turn the entire assembly upright and mark the location of the leg supports, according to the illustration above.
- B. Prepare the leg foundation as necessary. Install seat legs accordingly.
- C. We recommend to place at minimum 300 mm of the seat legs in concrete.