

**WARNING: READ THE ASSEMBLY INSTRUCTIONS CAREFULLY BEFORE ASSEMBLING THE DOUBLE BENCH SHELTER.**



Make sure to wear protective gloves and foot protection when installing and assembling this product. Unpack the unit and make sure all the components are included before proceeding. This activity requires two or more people as lifting is involved. Please ensure bolts are only finger tightened during the assembling process for flexibility in lining up components. Securely tighten the bolts before anchoring the Sheltered Park Setting to the ground.



**DOUBLE BENCH SHELTER**  
**(CODE No. FELDBSH)**

ITEM	DESCRIPTION	QTY
PDBS1	SIDE FRAME	2
PDBS2	SEAT PLANK –2040 mm.	1
PDBS3	ROOF ASSEMBLY	1
PDBS4	SEAT PLANK SUPPORTING BRACE	1
PDBS5	M6 x 25mm. HEX BOLT	16
PDBS6	M6 LOCK NUT	16
PDBS7	M12 x 45 mm. HEX. BOLT	4
PDBS8	M12 x 80 mm. HEX.BOLT	2
PDBS9	M12 x 110 mm. HEX.BOLT	4
PDBS10	M12 LOCKNUT	10
PDBS11	M12 PLAIN WASHER	20

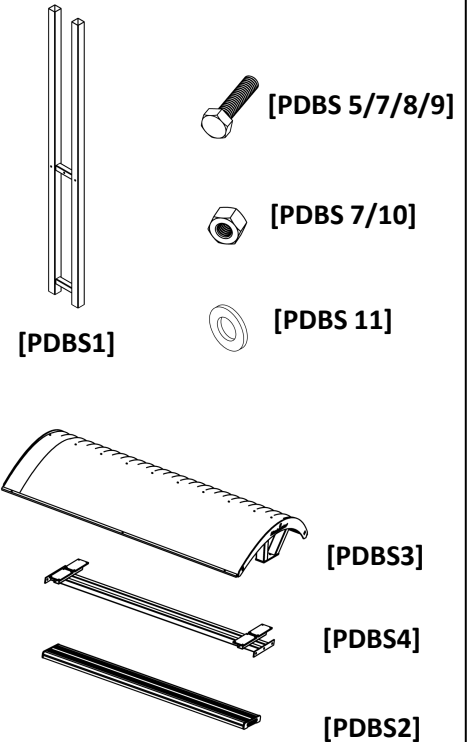

Thank you for purchasing our high quality products. The Double Bench Shelter has been manufactured with certified materials to achieve high reliability and minimum maintenance. It is our commitment to provide cost - effective solutions for outdoor applications.

**1**

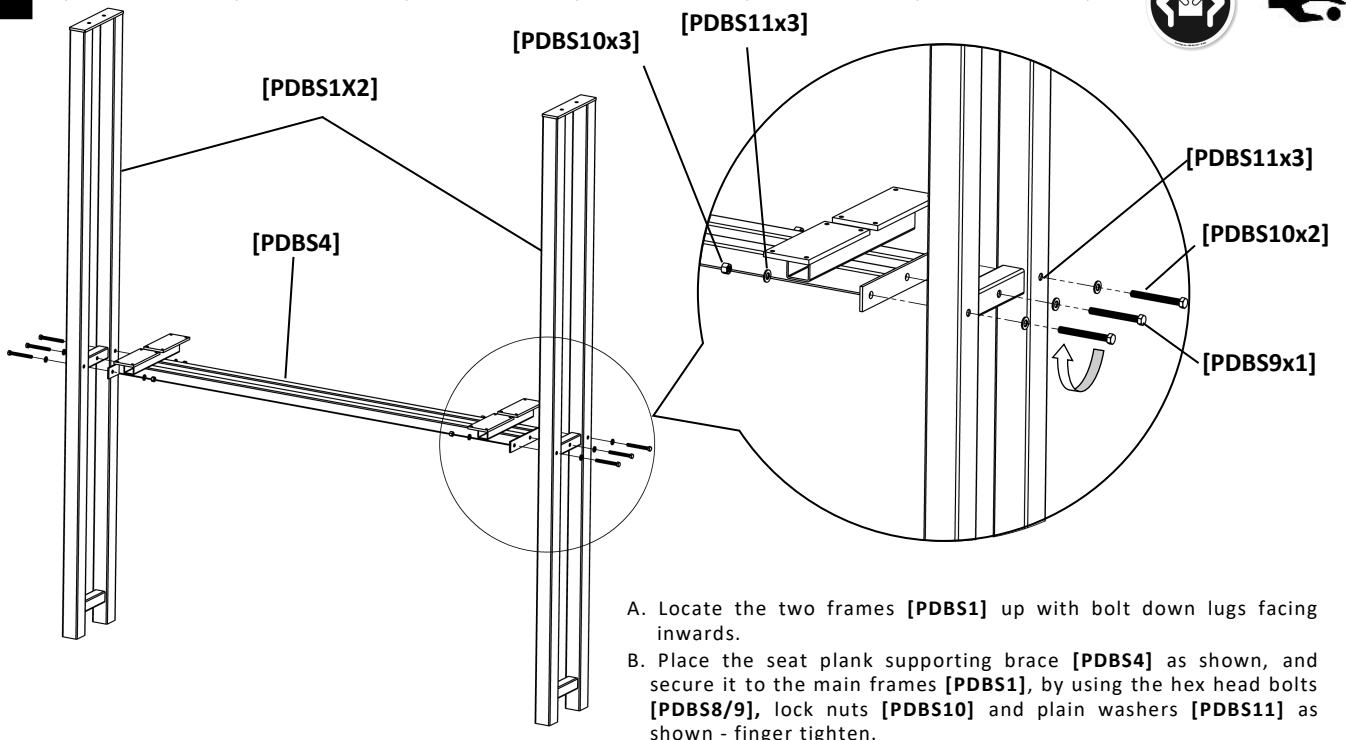

(IT CONTINUES ON THE BACK OF THIS SHEET)

**P1**

2

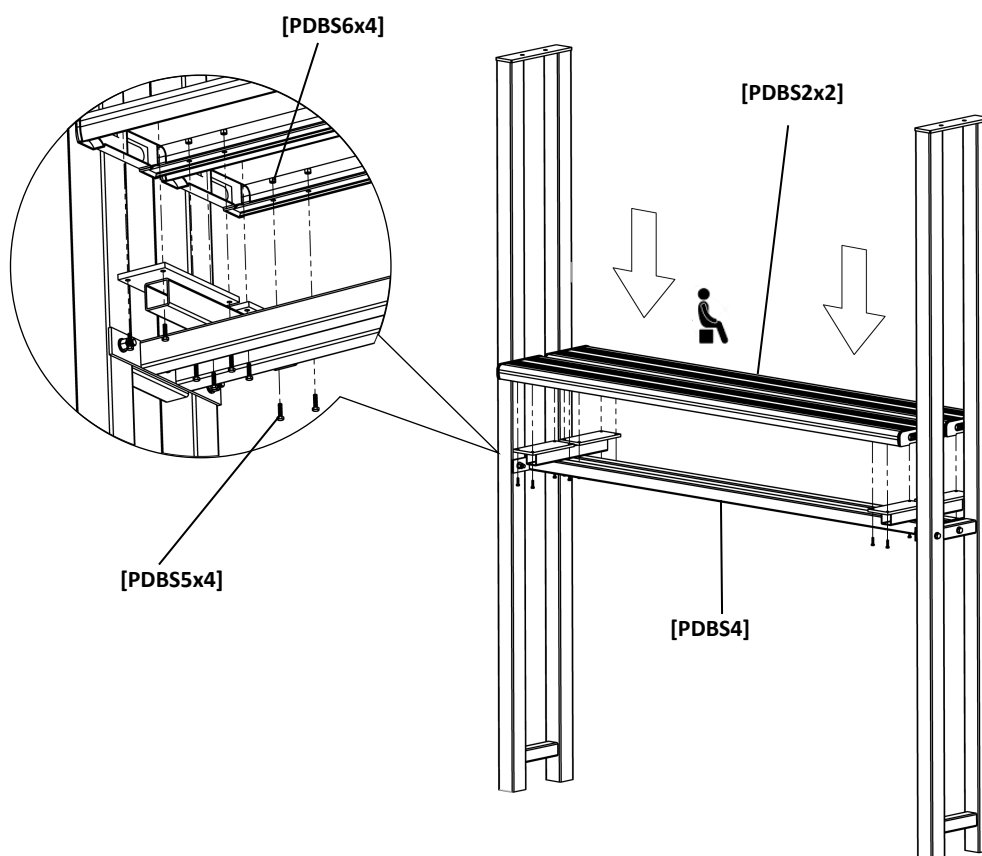

A. Place the table planks **[PDBS2]** on to the fixing plates of the supporting cross bar **[PDBS4]** and secure them, by using hex. head bolts **[PDBS5]** and lock nuts **[PDBS6]** - Finger tighten.

3

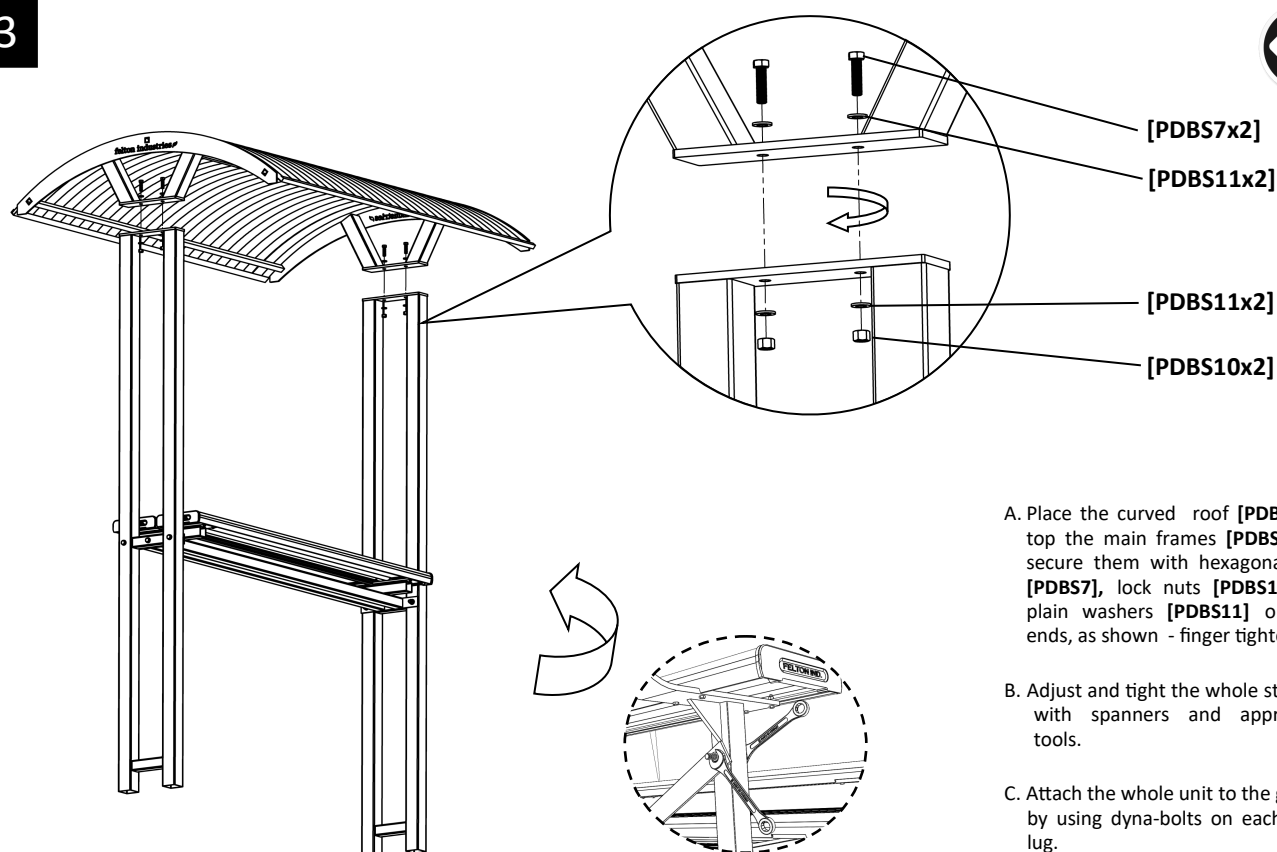

A. Place the curved roof **[PDBS3]** on top the main frames **[PDBS1]** and secure them with hexagonal bolts **[PDBS7]**, lock nuts **[PDBS10]** and plain washers **[PDBS11]** on both ends, as shown - finger tighten.

B. Adjust and tight the whole structure with spanners and appropriate tools.

C. Attach the whole unit to the ground, by using dyna-bolts on each frame lug.

P2

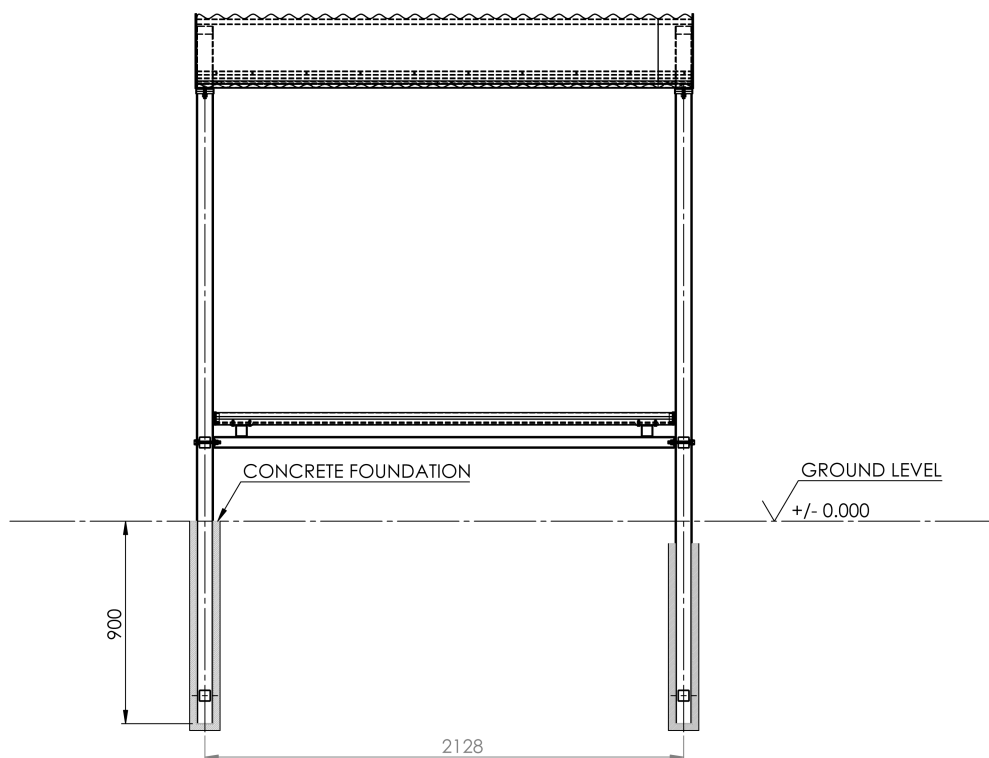

- A. Turn the entire assembly upright and mark the location of the supporting legs, according to the illustration above.
- B. Prepare the legs foundation as necessary.
- C. We recommend embedding the double bench shelter legs 900 mm. into concrete below ground level, in order to guarantee a comfortable seating height.