

ASSEMBLY INSTRUCTION

Thank You

FOR CHOOSING FELTON INDUSTRIES

KIDS ART TABLE  
[Code No: EZYSBT15]



"This product has been  
manufactured in Australia to the  
highest quality standard,  
guaranteeing proven quality,  
durability and low maintenance"



1800 22 00 55 1800 05 91 58  
sales@felton.net.au www.felton.net.au



Felton Industries Pty Ltd | ABN: 17 130 687 240



WARNING: This assembly required two or more people as lifting is involved. Please ensure bolts and nuts are only finger-tightened throughout assembly for flexibility in lining up components. Bolt and nuts should be securely tightened in place when instructed to do so. Please check all components are included before proceeding with the assembly

ITEM	DESCRIPTION	Qty
1	EZYSBT15_TABLE LEG SUPPORT	2
2	EZYSBT15_TABLE PLANK L1500	2
3	AS-NZS 2465 Bolt - 1/4" x 1"	16
4	AS-NZS NYLON Nut - 1/4"	16

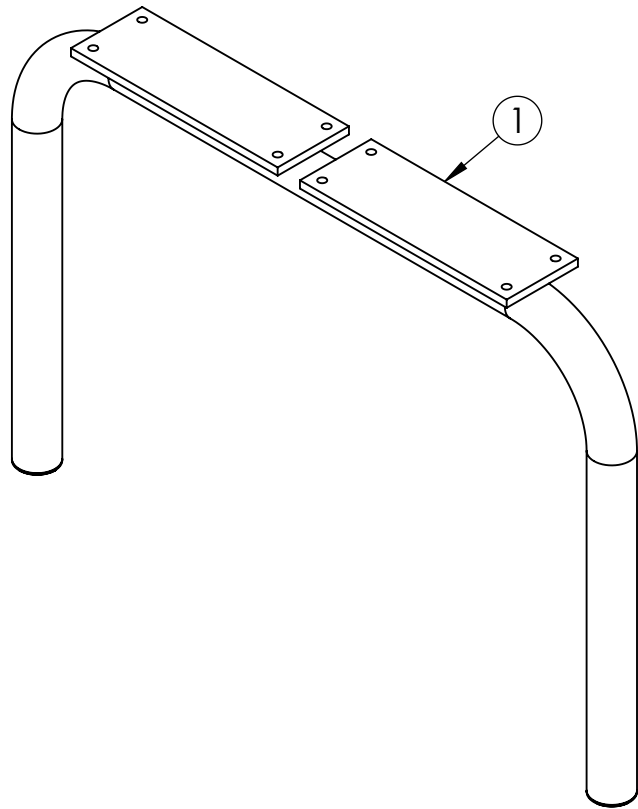
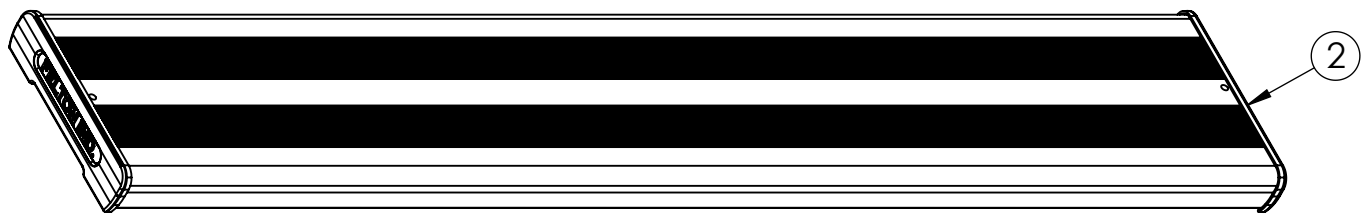
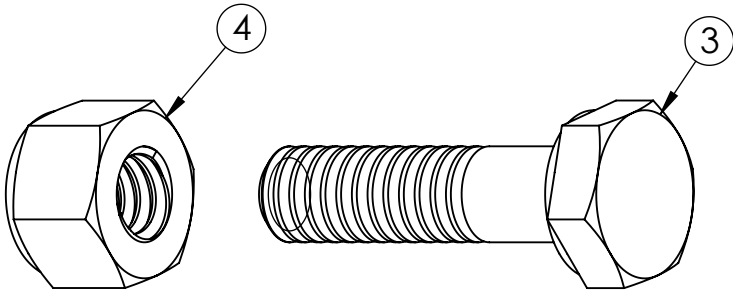

1

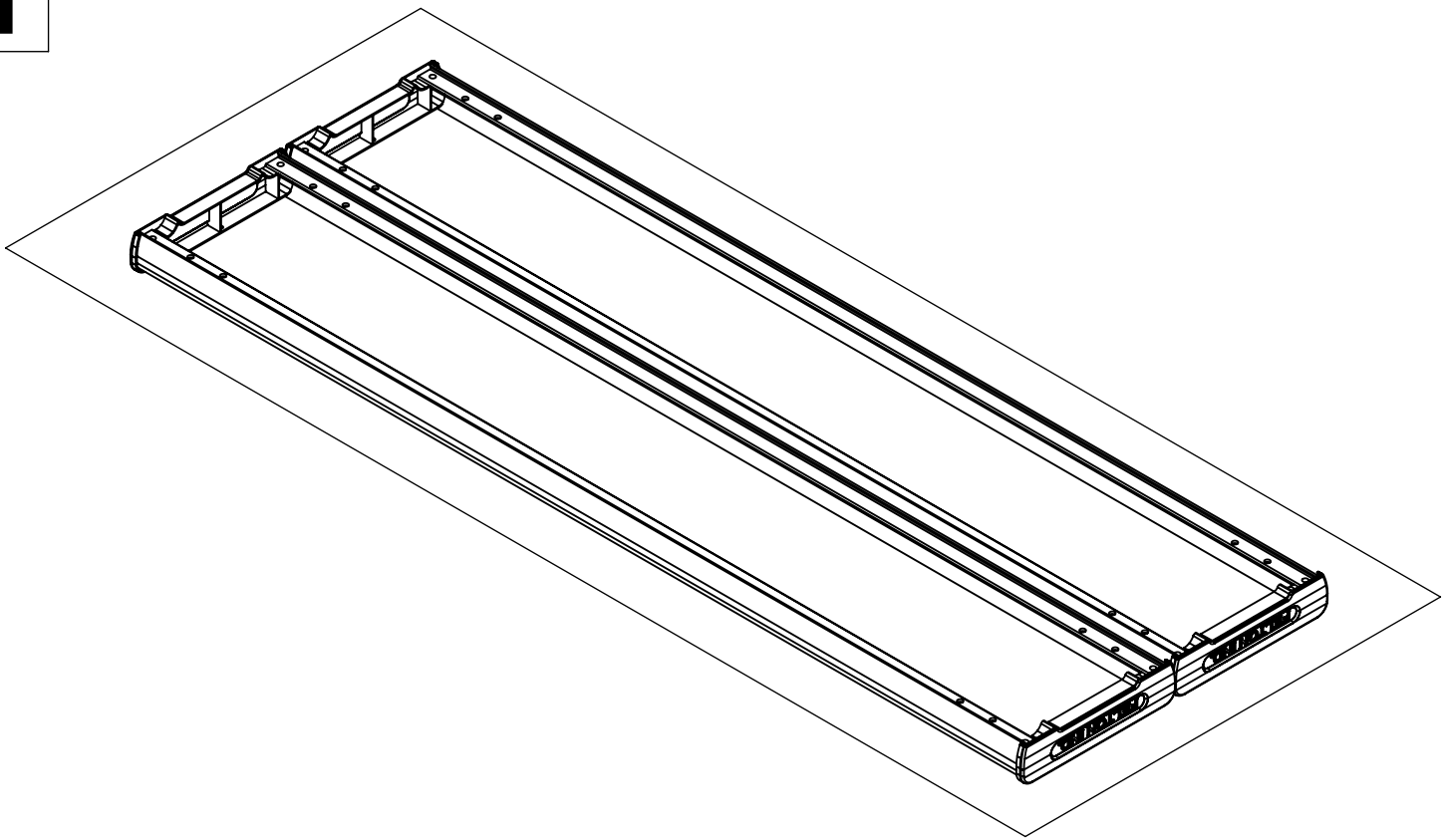

Place two planks (2) up side down on the flat ground as illustrated.

3

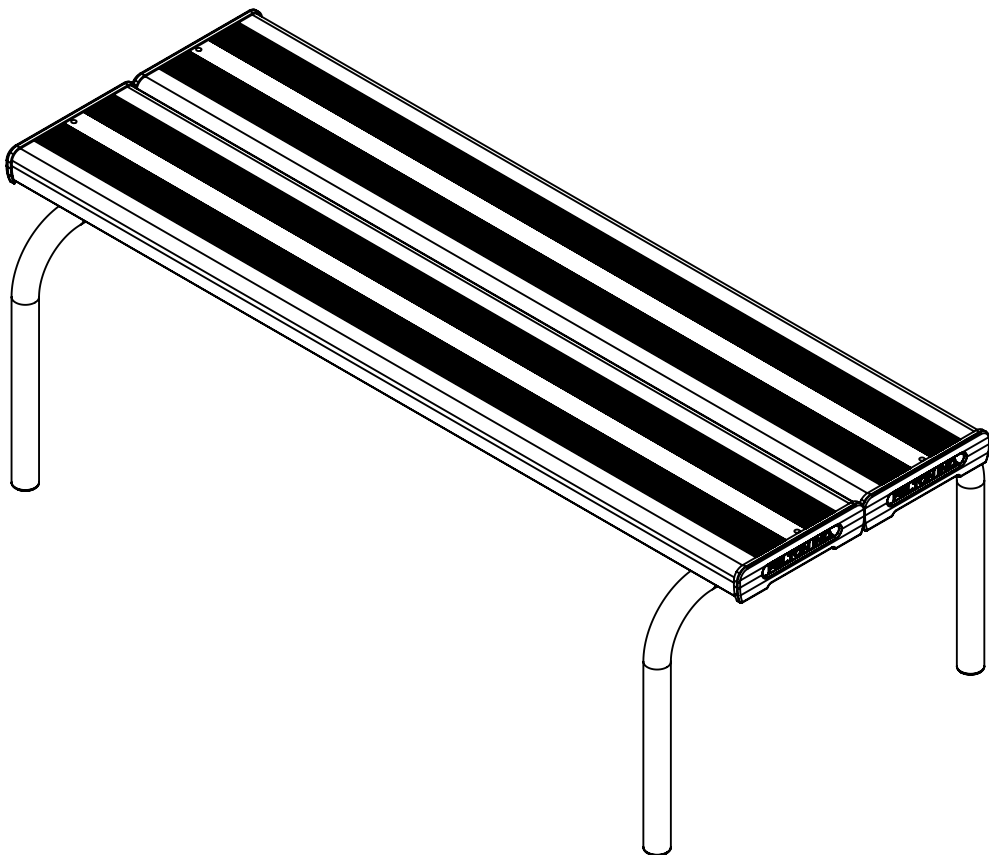

Tighten all hexagonal head bolts with spanners and appropriate tools. Then turn the assembly up.

2

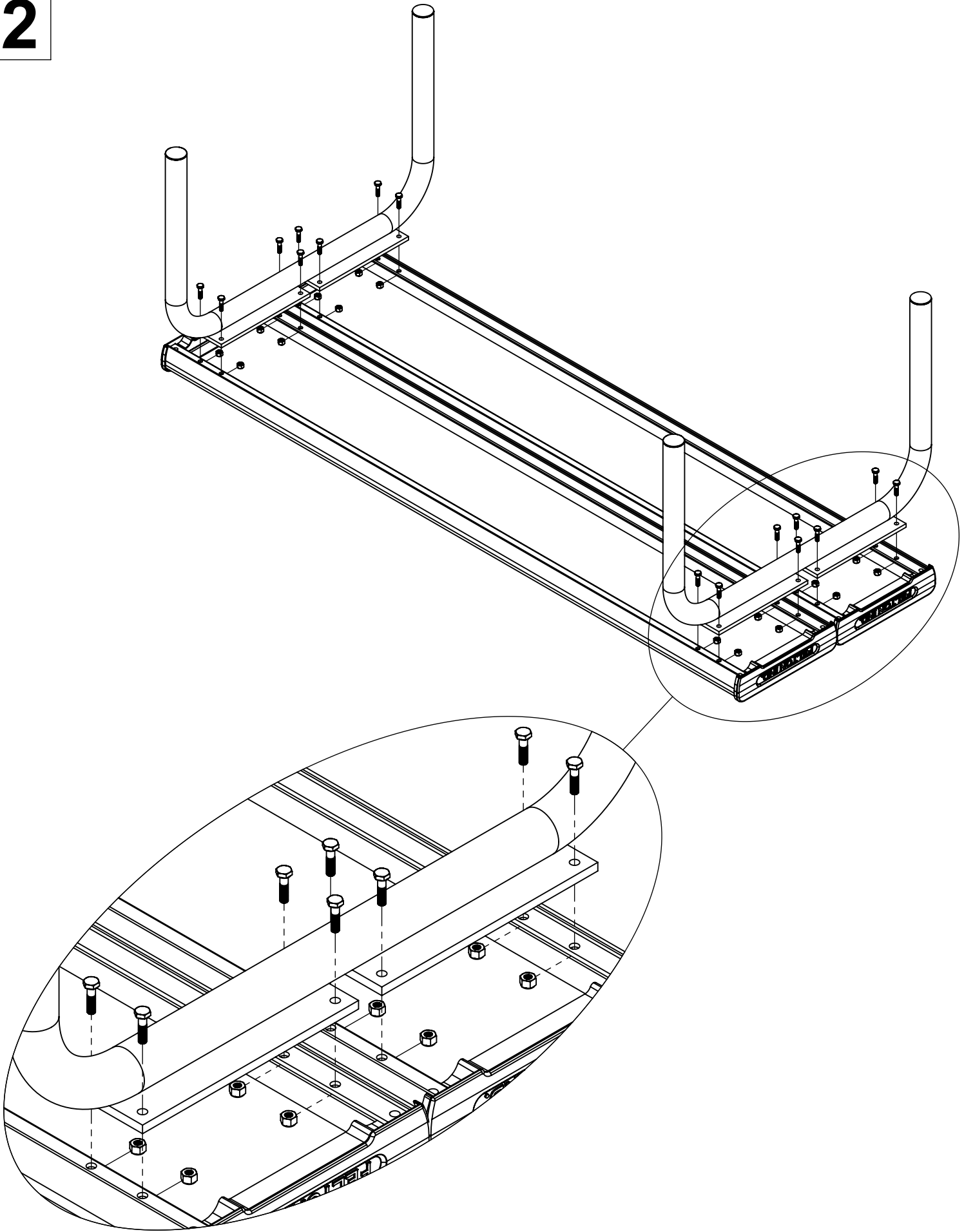

Attach to two table leg supports (1) to the assembly in step 1 by using bolts (3) and nuts (4) as illustrated.