

# ASSEMBLY INSTRUCTION

*Thank You*

FOR CHOOSING FELTON INDUSTRIES

4 SIDED PEDESTAL PARK SETTING  
[Code No: FEL4PPS]



"This product has been manufactured in Australia to the highest quality standard, guaranteeing proven quality, durability and low maintenance"



1800 22 00 55

1800 05 91 58

sales@felton.net.au

www.felton.net.au



Felton Industries Pty Ltd | ABN: 17 130 687 240



WARNING: This assembly required two or more people as lifting is involved. Please ensure bolts and nuts are only finger-tightened throughout assembly for flexibility in lining up components. Bolt and nuts should be securely tightened in place when instructed to do so. Please check all components are included before proceeding with the assembly

ITEM	DESCRIPTION	Qty
1	FEL4PPS_SEAT FRAME	4
2	FEL4PPS_SEAT PLANK L900	4
3	FEL4PPS_SEAT CONNECTION BAR	2
4	FEL4PPS_SEAT CONNECTION BAR(1)	2
5	FEL4PPS_MAIN COLUMN	1
6	FEL4PPS_TABLE FRAME	1
7	FEL4PPS_TABLE PLANK L1000	4
8	AS-NZS 2465 Bolt - 1/4" x 1"	64
9	AS-NZS NYLON Nut - 1/4"	64
10	AS-NZS 2465 Bolt - 3/8" x 4"	12
11	AS-NZS 2465 Washer - 3/8"	24
12	AS-NZS 2465 Nut - 3/8"	12
13	AS-NZS 2465 Bolt - 1/2" x 3.5"	2
14	AS-FLAT Washer - 1/2"	4
15	AS-NZS NYLON Nut - 1/2"	2

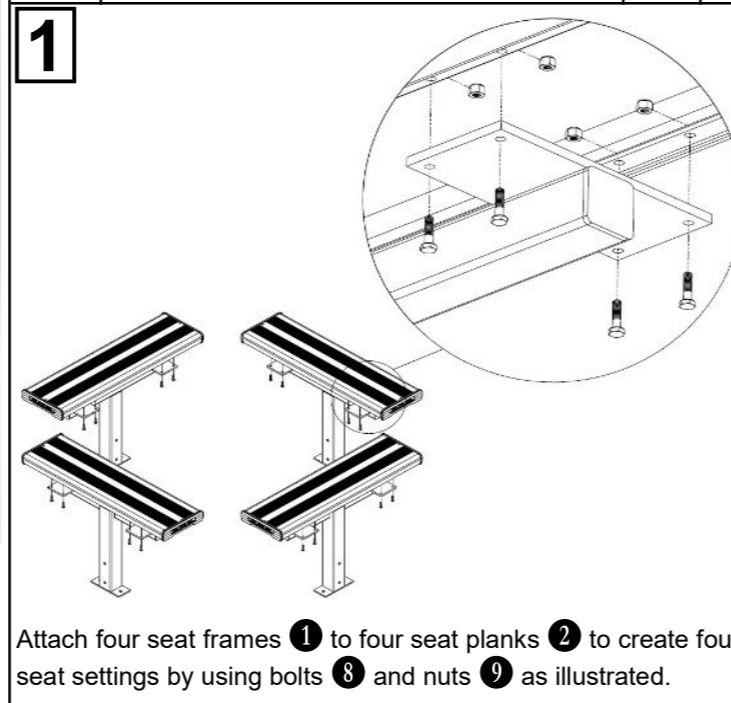
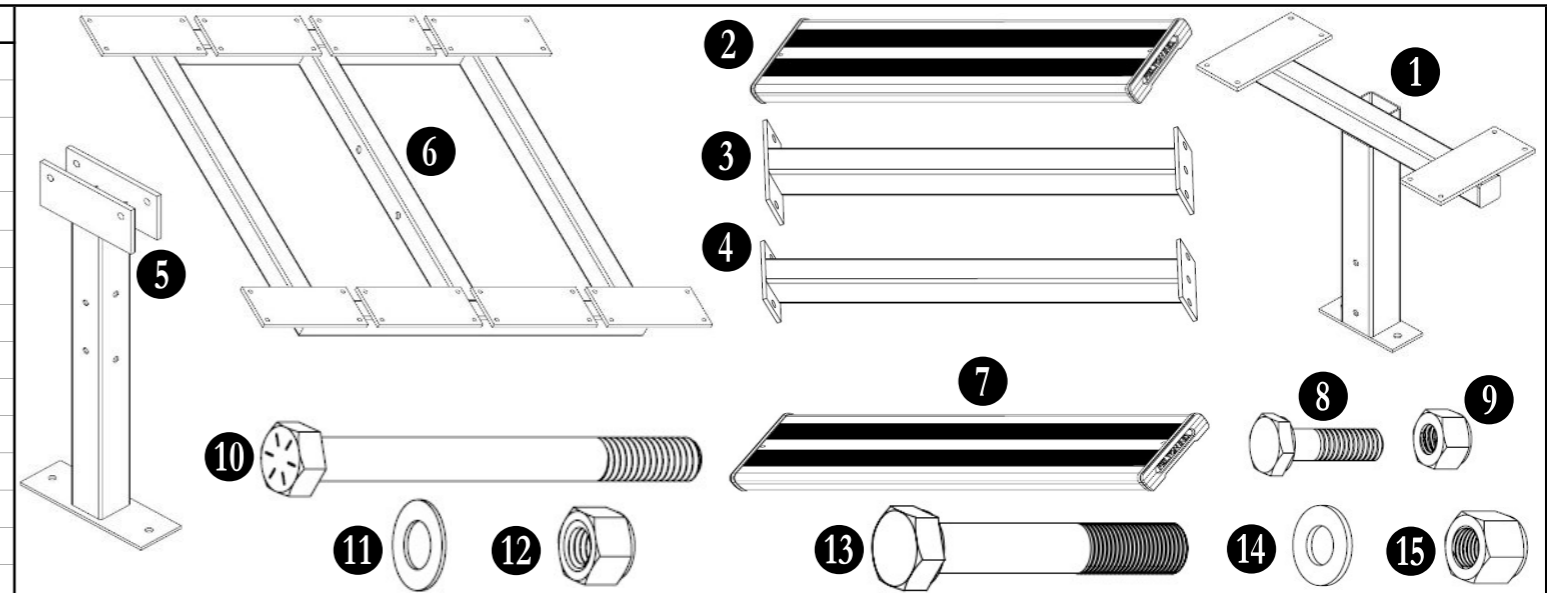

Attach four seat frames 1 to four seat planks 2 to create four seat settings by using bolts 8 and nuts 9 as illustrated.

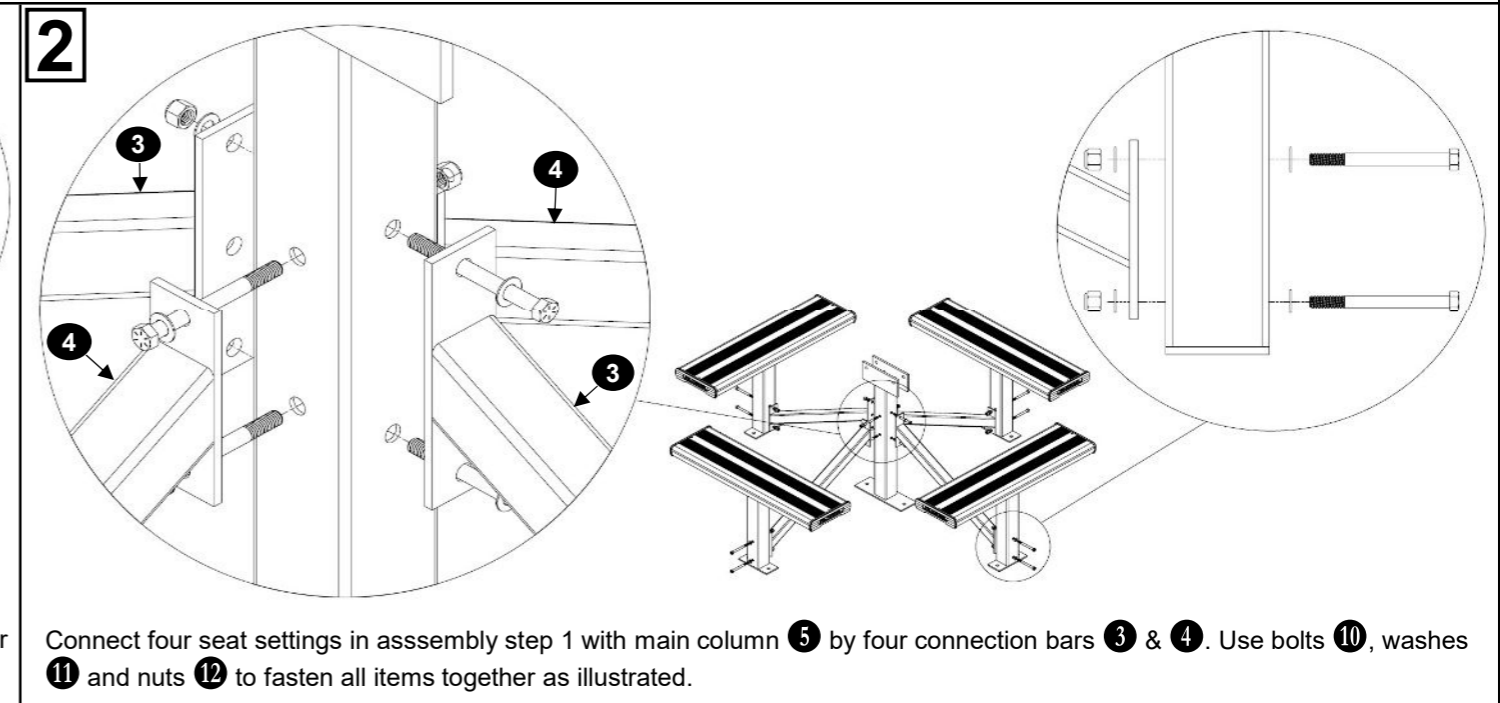

Connect four seat settings in assembly step 1 with main column 5 by four connection bars 3 & 4. Use bolts 10, washes 11 and nuts 12 to fasten all items together as illustrated.

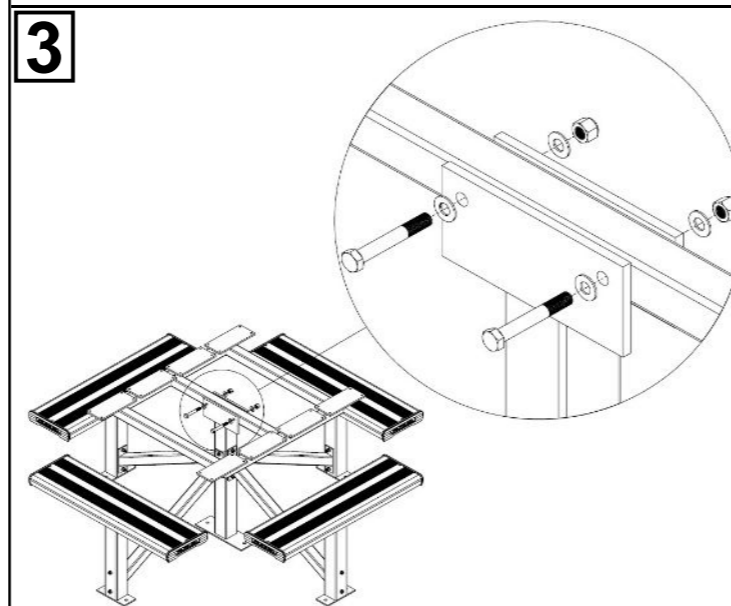

Attach the table frame 6 to the the main column 5 by using bolts 13, washes 14 and nuts 15 as illustrated.

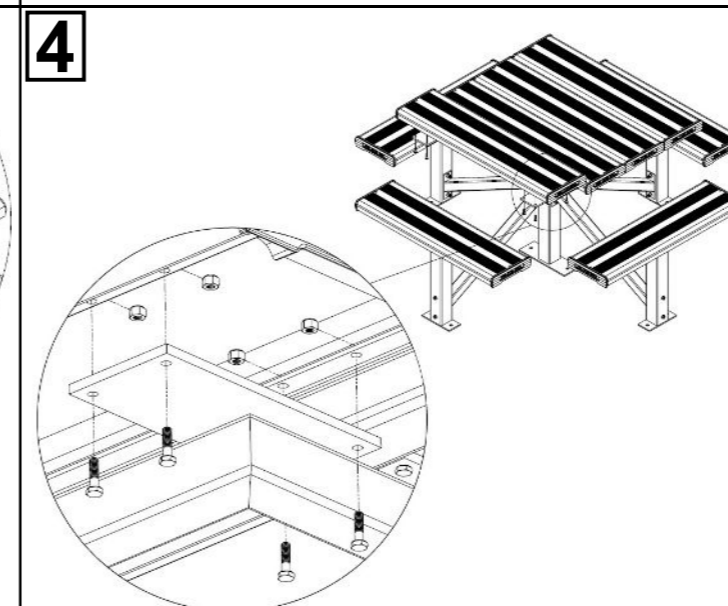

Attach four table planks 7 onto the table frame 6 by using bolts 8 and nuts 9 as illustrated.

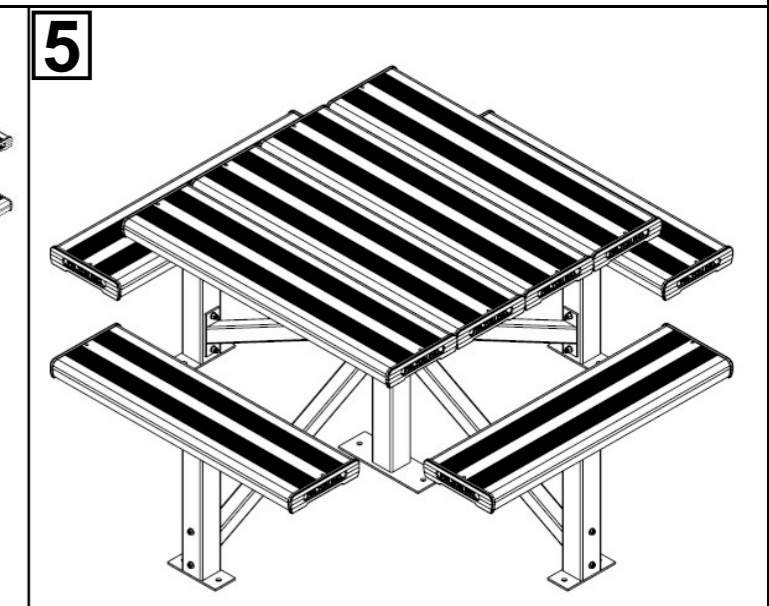

Tighten all hexagonal head bolts with spanners and appropriate tools. Then attach the whole assembly to the ground by using M12 dyna-bolts preferably on each ground fixing plate.