

# ASSEMBLY INSTRUCTION

*Thank You*

**FOR CHOOSING FELTON INDUSTRIES**

**DELUXE BROAD ROOF SHELTERED  
PARK SETTING  
[Code No:FELBRPT]**



**WARNING:** This assembly required two or more people as lifting is involved. **Please ensure bolts and nuts are only finger-tightened throughout assembly for flexibility in lining up components.** Bolt and nuts should be securely tightened in place when instructed to do so. Please check all components are included before proceeding with the assembly

ITEM	DESCRIPTION	Qty
1	FELBRPT_MAIN FRAME	2
2	FELBRPT_CONNECTION BAR	1
3	FELBRPT_SEAT PLANK L2315	2
4	FELBRPT_TABLE PLANK L2020	3
5	FELBRPT_ROOF	1
6	AS-NZS 2465 Bolt - 1/2" x 3.5"	4
7	AS-FLAT WASHER - 1/2"	16
8	AS-NZS NYLON Nut - 1/2"	8
9	AS-NZS 2465 Bolt - 1/4" x 1"	40
10	AS-NZS NYLON Nut - 1/4"	40
11	AS-NZS 2465 Bolt - 1/2" x 1.5"	4

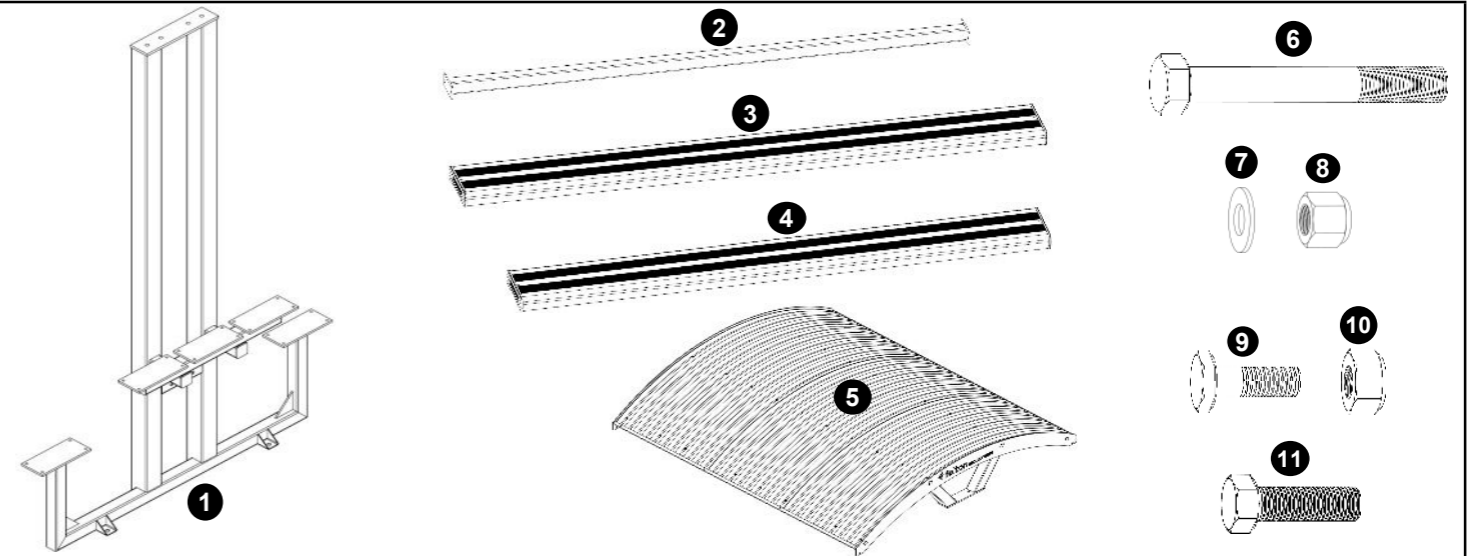

**1**

Attach the two main frames **1** to the connection bar **2** by using bolts **6**, washes **7** and nuts **8**. Note that frame tags facing inward.

**2**

Install three table planks **4** onto frame fixing plates as illustrated. Fasten the table planks **4** with hexagonal bolts **9** and nuts **10**

**3**

Install two seat planks **3** onto frame fixing plates as illustrated. Fasten the seat planks **3** with hexagonal bolts **9** and nuts **10**

**4**

Attach the roof **5** to the main frames **1**. Fasten the roof **5** with hexagonal bolts **11**, washes **7** and nuts **8**

**5**

Tighten all hexagonal head bolts with spanners and appropriate tools. Then attach the whole assembly to the ground by using dyna-bolts preferably, on each frame lug.

"This product has been manufactured in Australia to the highest quality standard, guaranteeing proven quality, durability and low maintenance"



1800 22 00 55

1800 05 91 58

sales@felton.net.au

www.felton.net.au



Felton Industries Pty Ltd | ABN: 17 130 687 240