

ASSEMBLY INSTRUCTION

Thank You

FOR CHOOSING FELTON INDUSTRIES

EDUCATIONAL BIN ENCLOSURE 240 Ltr
[Code No: FELED240]



"This product has been manufactured in Australia to the highest quality standard, guaranteeing proven quality, durability and low maintenance"



☎ 1800 22 00 55

🖨 1800 05 91 58

✉ sales@felton.net.au

🌐 www.felton.net.au



Felton Industries Pty Ltd | ABN: 17 130 687 240



WARNING: This assembly required two or more people as lifting is involved. **Please ensure bolts and nuts are only finger-tightened throughout assembly for flexibility in lining up components.** Bolt and nuts should be securely tightened in place when instructed to do so. Please check all components are included before proceeding with the assembly

ITEM	DESCRIPTION	Qty
1	FELED240_SIDE PANEL	2
2	FELED240_TOP LID	1
3	FELED240_BACK PANEL	1
4	FELED240_FRONT DOOR	1
5	FELED240_BASE PLATE	2
6	LOCK	1
7	HINGE	2
8	Hex Head Screws - M5x0.8 x L10	16
9	Washer - M5	16
10	Hex Head Screws - M6x1 x L12	18

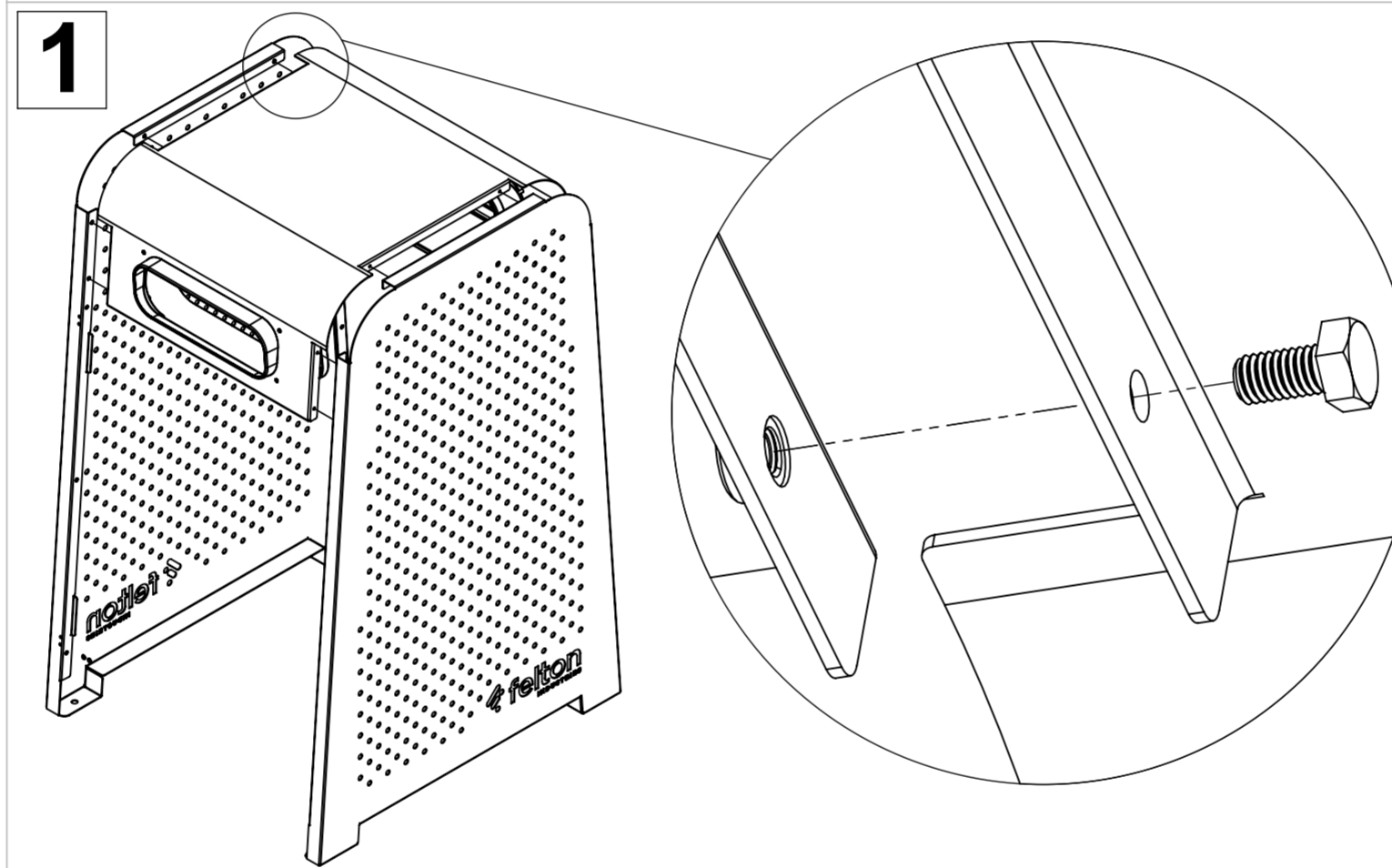
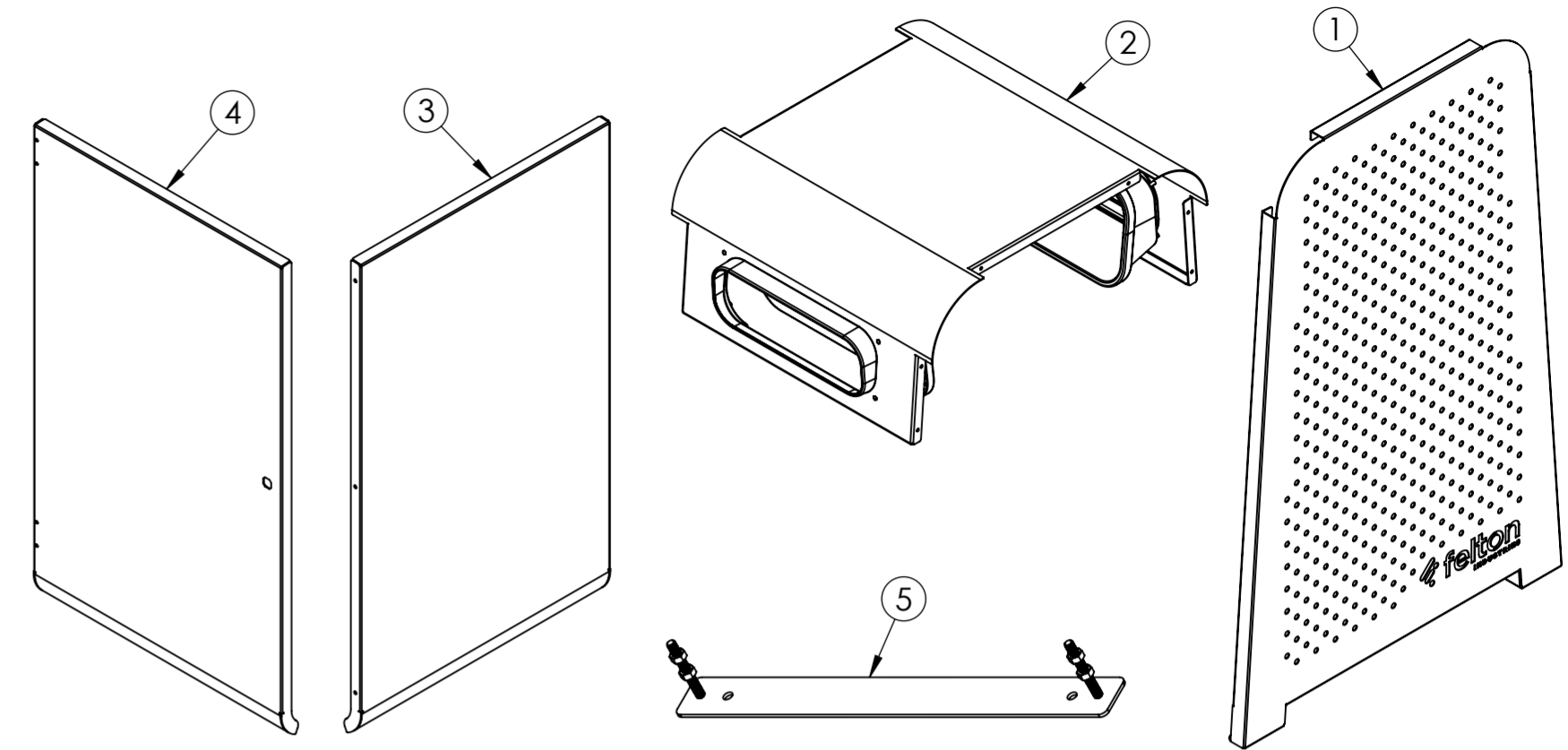
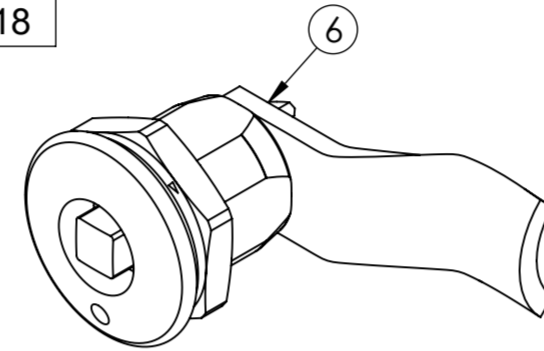
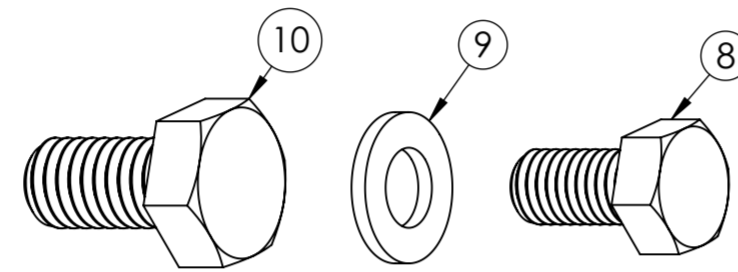

Use screws (10) to fasten two side panels (1) and the top lid (2) together as illustrated.

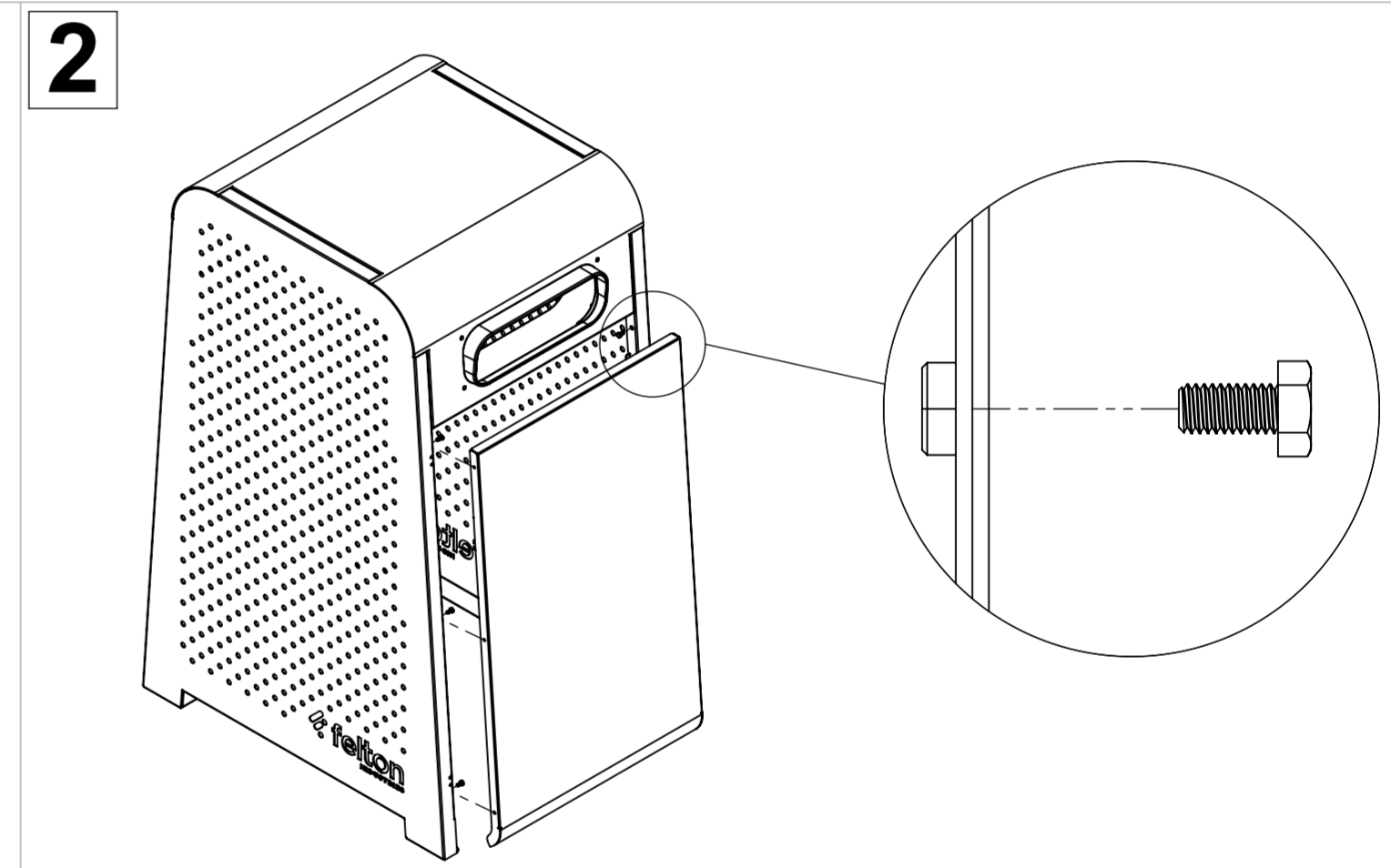

Attach the back panel (3) to the back of the assembly in step 1 by using screws (10) as illustrated.

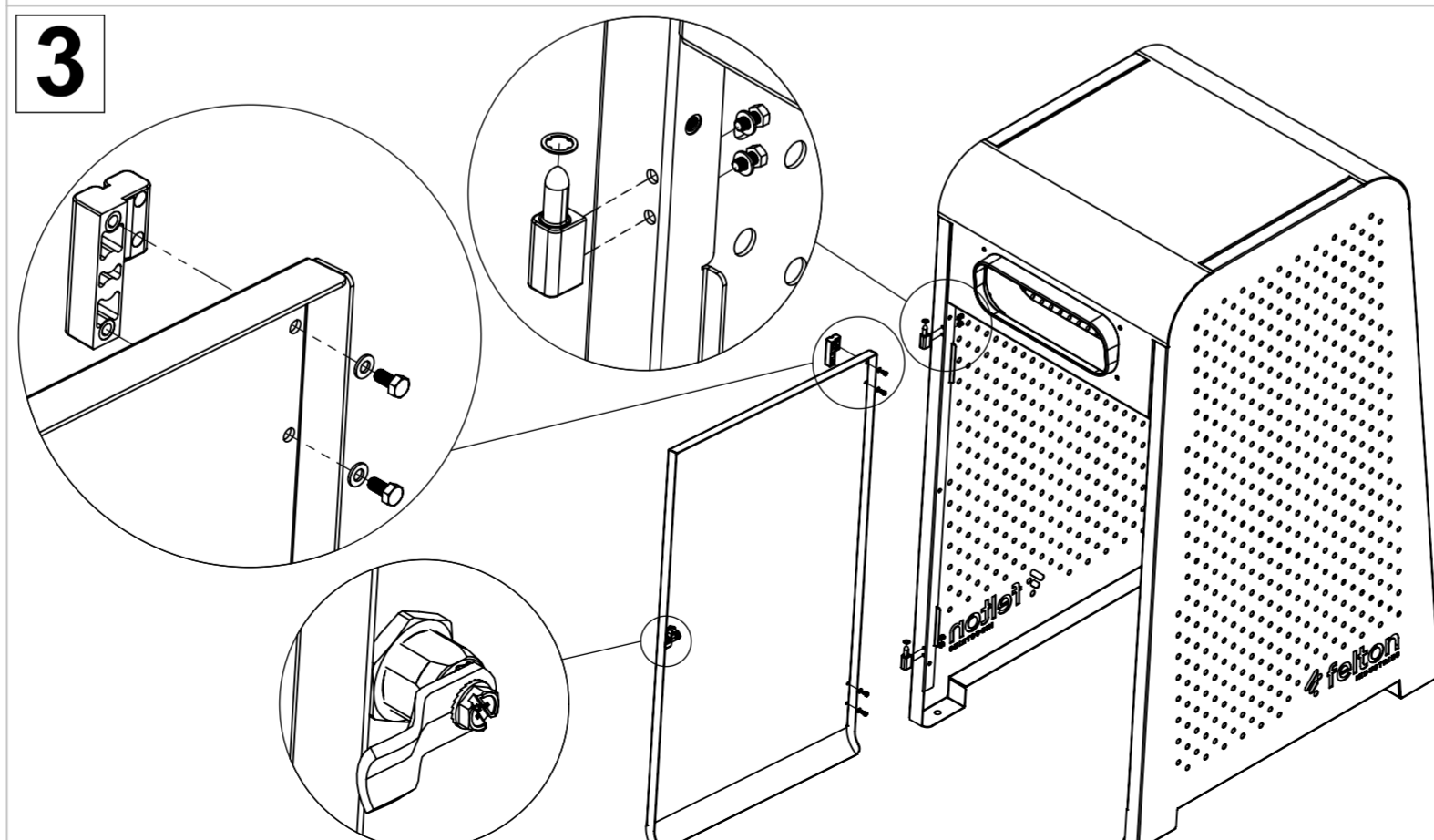

Attach two hinges (7) to the door panel (4) and the left side panel (1) by using screws (8) and washers (9) as illustrated. Then attach the lock (6) to the door panel (4)

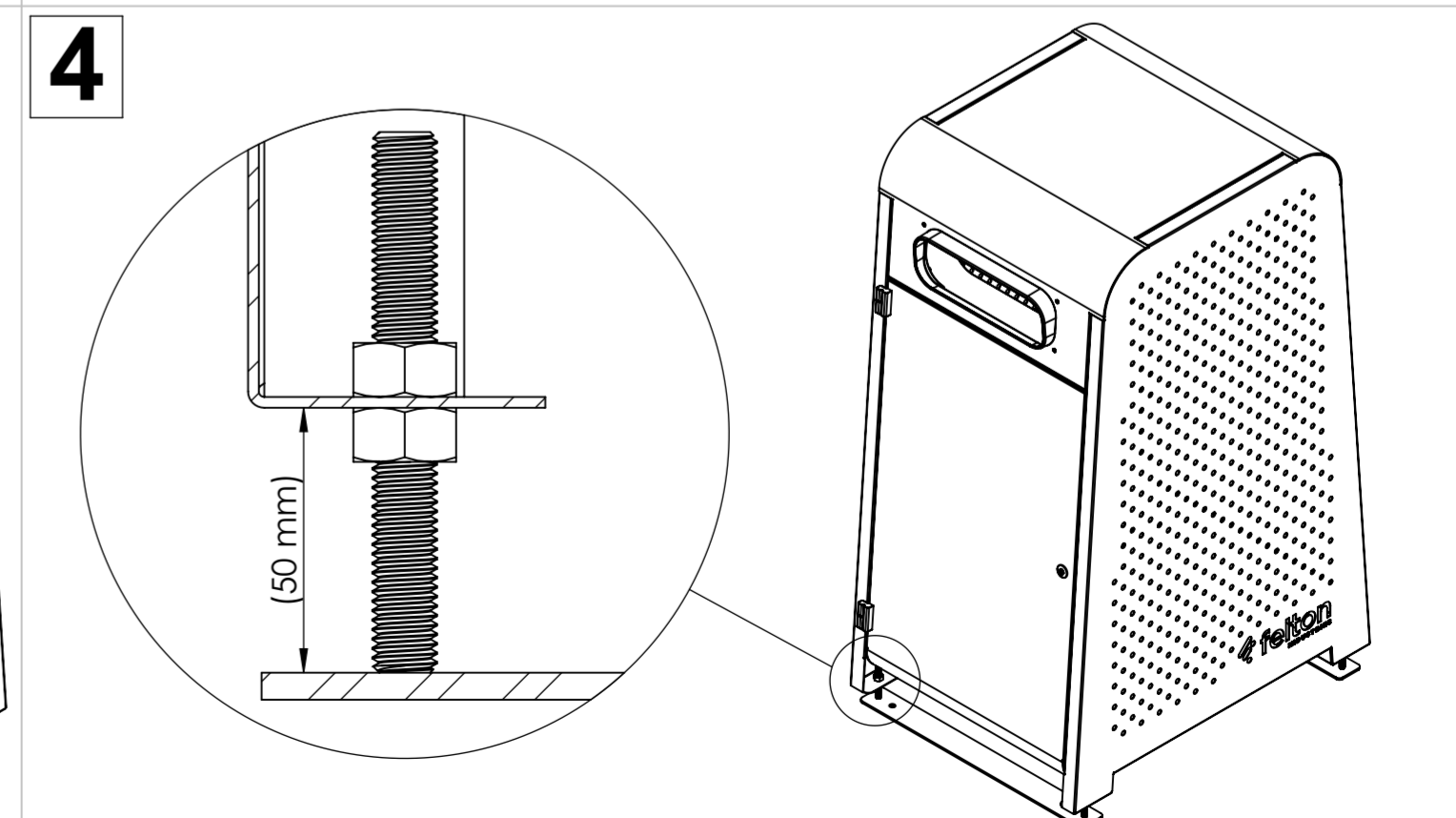

Place the assembly in step 3 on two base plates (5). Then adjust the nuts M12 at four corners on the base plates to set the height (recommendation 50 mm) as illustrated. Make sure the bin is well-balanced. Tighten all socket head screws with hex key and appropriate tools. Then attach the whole assembly to the ground by using M12 dyna-bolts preferably, on each base plate.