

# ASSEMBLY INSTRUCTION

Thank You

FOR CHOOSING FELTON INDUSTRIES

6mtr ELITE PORTABLE GRANDSTAND  
[Code No: FELEPG5T6]



"This product has been  
manufactured in Australia to the  
highest quality standard,  
guaranteeing proven quality,  
durability and low maintenance"



1800 22 00 55

1800 05 91 58

sales@felton.net.au

www.felton.net.au



Felton Industries Pty Ltd | ABN: 17 130 687 240



WARNING: This assembly required two or more people as lifting is involved. Please ensure bolts and nuts are only finger-tightened throughout assembly for flexibility in lining up components. Bolt and nuts should be securely tightened in place when instructed to do so. Please check all components are included before proceeding with the assembly

ITEM	DESCRIPTION	Qty
1	FELEPG5T6_BASE FRAME	5
2	FELEPG5T6_GROUND CHANNEL	3
3	FELEPG5T6_PLANK L3075	18
4	FELEPG5T6_PLANK L4975	4
5	FELEPG5T6_SKIRTING BOARD L3000	10
6	FELEPG5T6_SKIRTING BOARD L1510	6
7	FELEPG5T6_STAIR PLANK L1432	4
8	AS-NZS 2465 Bolt - 1/4" x 1"	244
9	AS-NZS NYLON Nut - 1/4"	244
10	AS-NZS 2465 Bolt - 1/2" x 3.5"	37
11	AS-FLAT WASHER - 1/2"	98
12	AS-NZS NYLON Nut - 1/2"	49
13	AS-Screw-ST4.5x25	84
14	AS 1112 Bolt - 3/8" x 3"	16
15	AS 1112 Nut - 3/8"	16

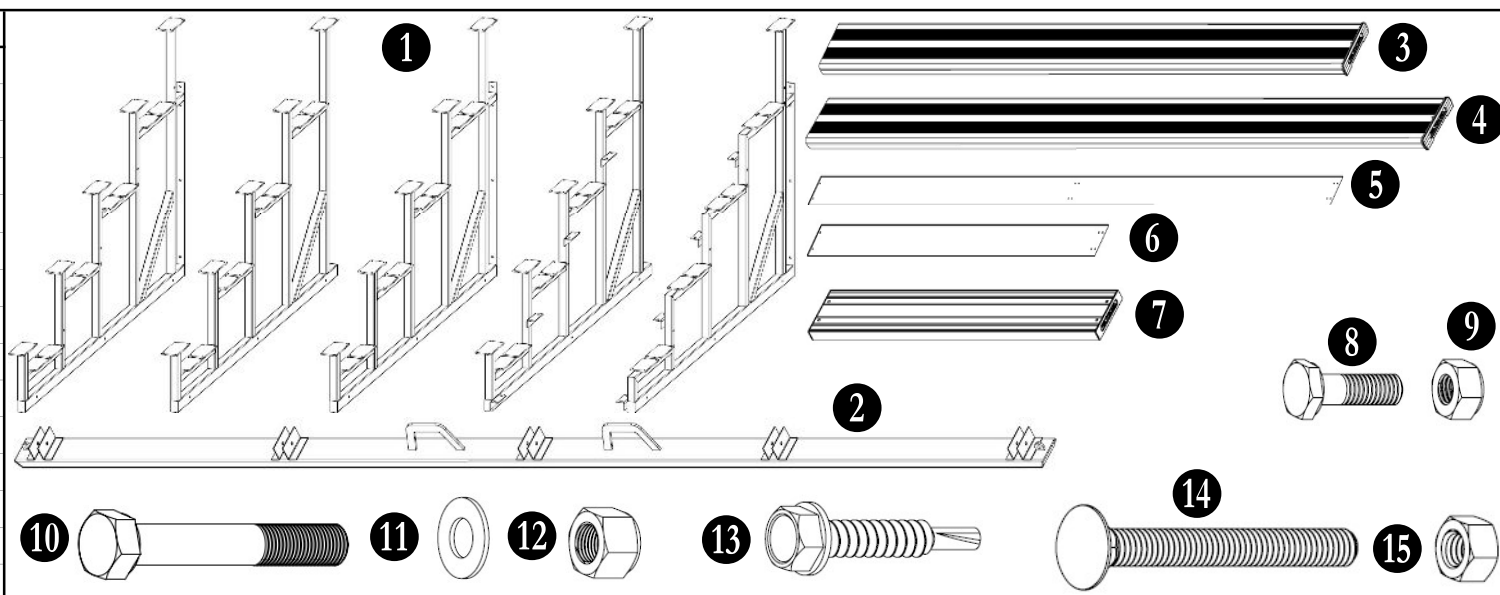

1

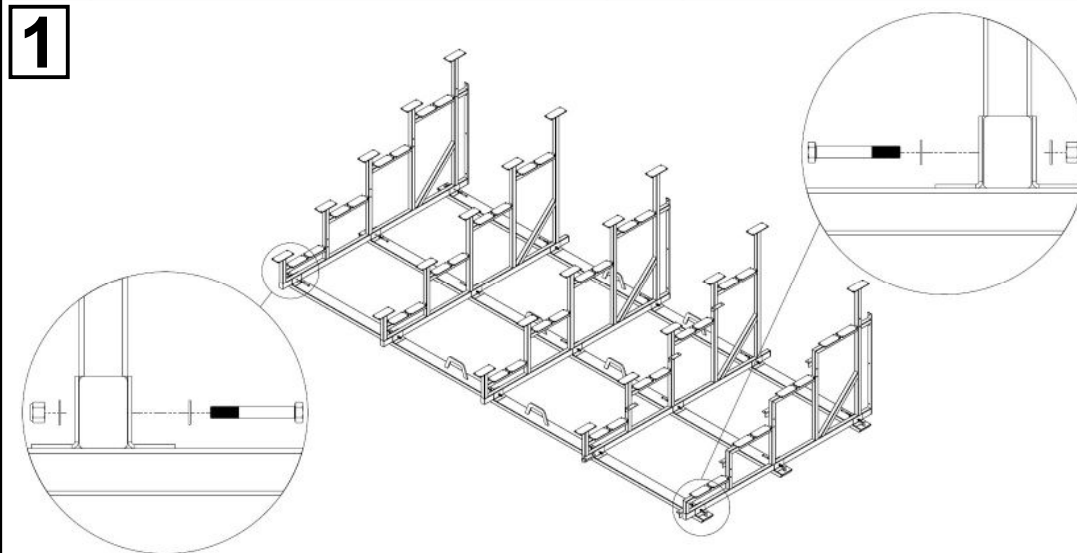

Attach five base frames 1 to three ground channels 2 by using bolts 10, washers 11 and nuts 12 as illustrated.

2

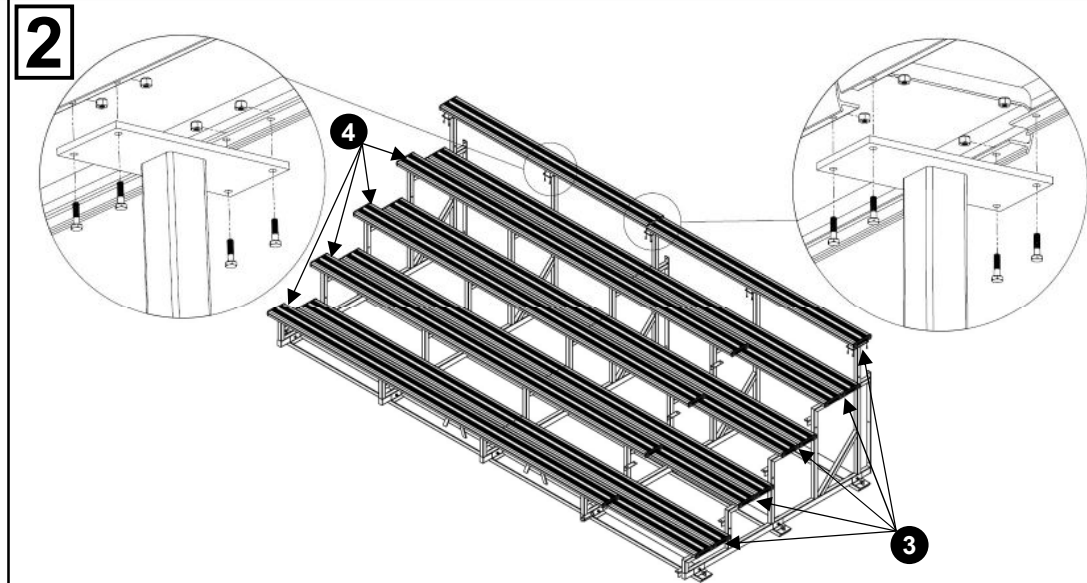

Attach eighteen short planks 3 and four long planks 4 onto five base frames 1 by using bolts 8 and nuts 9 as illustrated. Note that all planks should be attached from top to bottom.

3

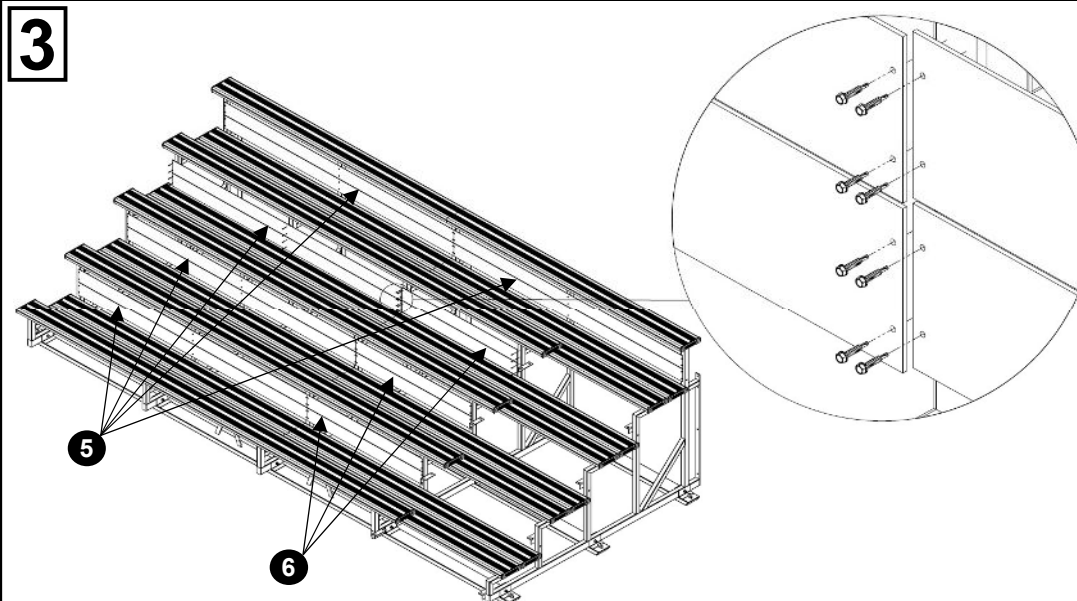

Fasten ten long skirting boards 5 and six short skirting boards 6 firmly onto vertical tubes on all base frames by using self-tapping screws 13. Ensure that boards 5 & 6 are fastened from joining points as illustrated towards outer ends to avoid length shortage.

4

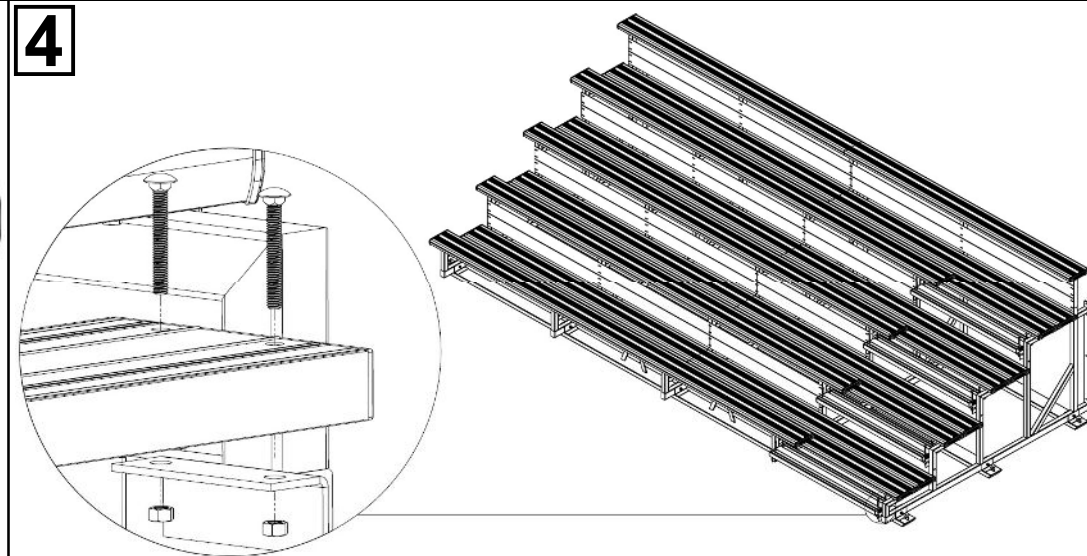

Attach four stair planks 7 onto base frames by using bolts 14 and nuts 15 as illustrated.



# ASSEMBLY INSTRUCTION

*Thank You*

FOR CHOOSING FELTON INDUSTRIES

6mtr ELITE PORTABLE GRANDSTAND  
[Code No: FELEPG5T6]



"This product has been  
manufactured in Australia to the  
highest quality standard,  
guaranteeing proven quality,  
durability and low maintenance"



1800 22 00 55

1800 05 91 58

sales@felton.net.au

www.felton.net.au



Felton Industries Pty Ltd | ABN: 17 130 687 240



WARNING: This assembly required two or more people as lifting is involved. Please ensure bolts and nuts are only finger-tightened throughout assembly for flexibility in lining up components. Bolt and nuts should be securely tightened in place when instructed to do so. Please check all components are included before proceeding with the assembly

ITEM	DESCRIPTION	Qty
16	FELEPG5T6_MAIN UPRIGHT BAR	3
17	FELEPG5T6_AL TUBE 25x25xL3210	4
18	FELEPG5T6_BACK RAILING	2
19	FELEPG5T6_LEFT SIDE RAILING	1
20	FELEPG5T6_RIGHT SIDE RAILING	1
21	AS-NZS 2465 Bolt - 1/2" x 4.5"	6
22	AS-NZS 2465 Bolt - 1/2" x 5.5"	4
23	AS-NZS 2465 Bolt - 1/2" x 6.5"	2

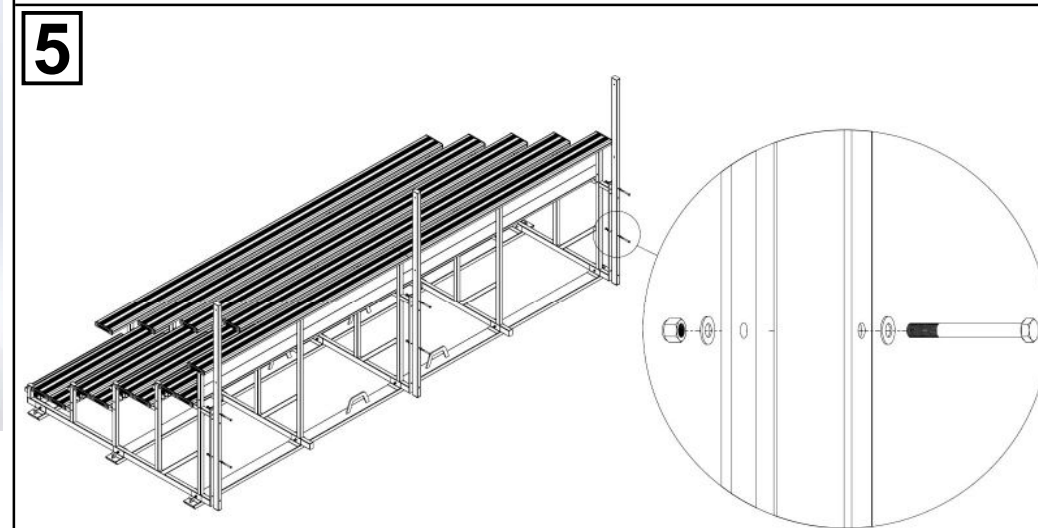
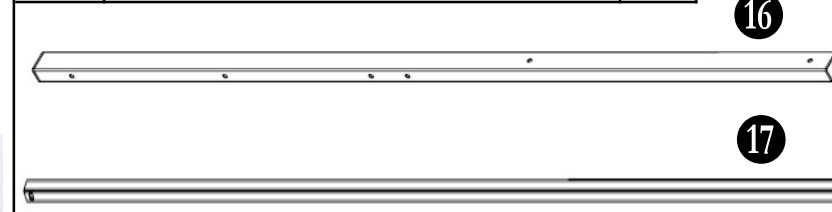
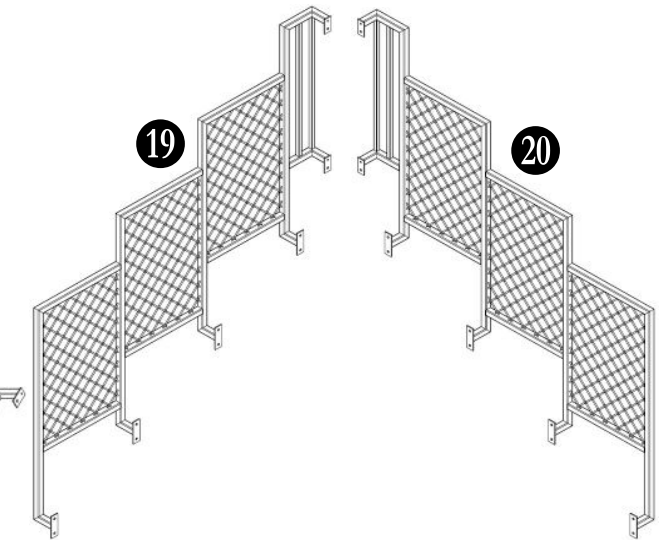
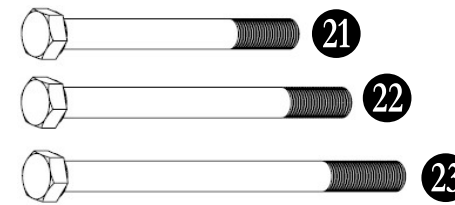

Attach three upright bars 16 to the back of base frames by using bolts 21, washers 11, and nuts 12 as illustrated. Ensure all fasteners are attached at the right positions on upright bars.

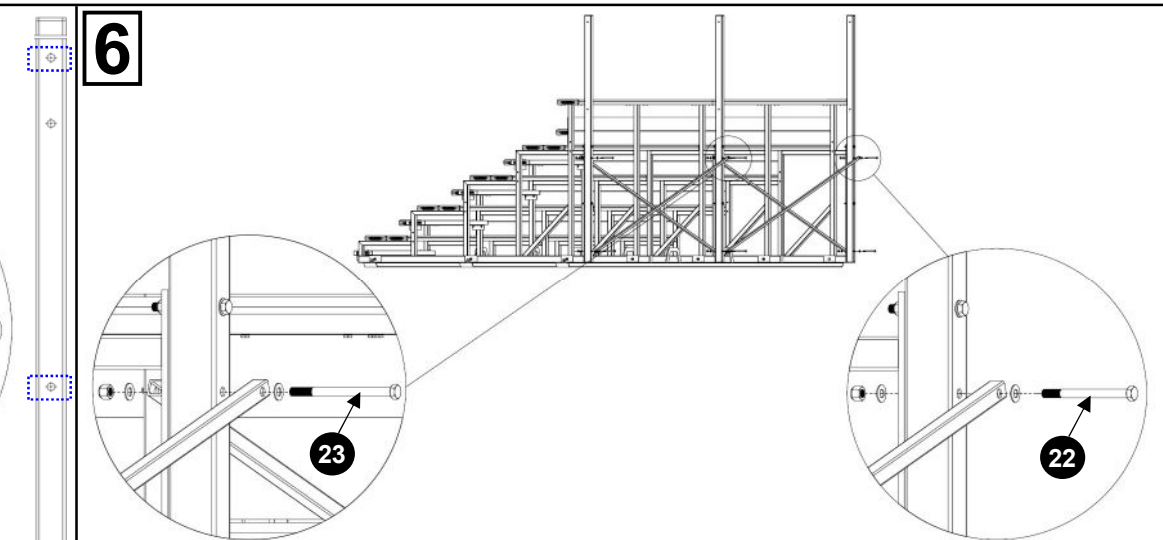

Attach four tubes 25x25 17 onto base frames and upright bars to support the assembly structure by using bolts 22, bolts 23, washers 11, and nuts 12 as illustrated.

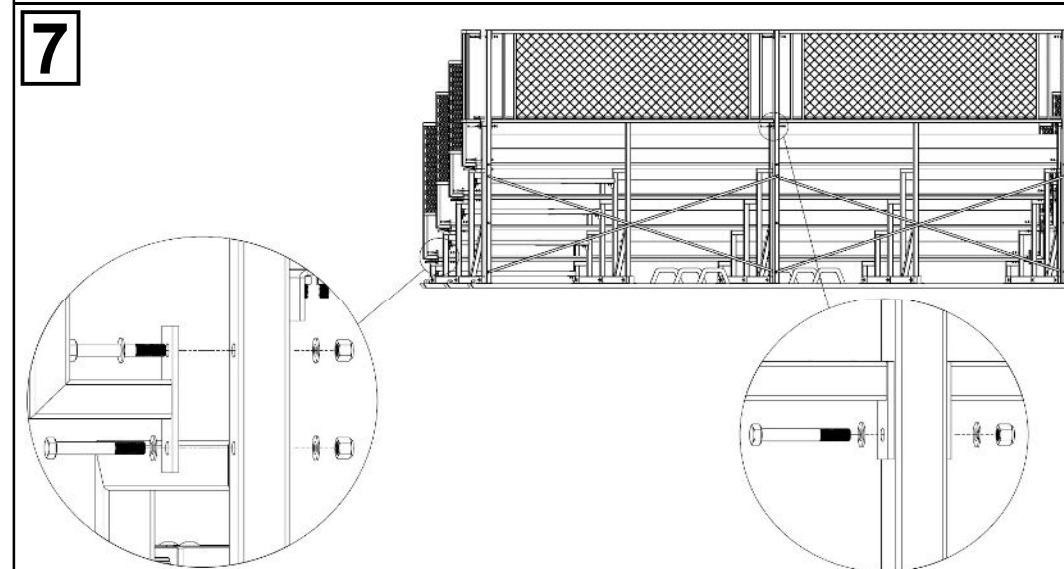

Attach back railing 18, left side railing 19, and right side railing 20 to base frames by using bolts 10, washers 11 and nuts 12 as illustrated.

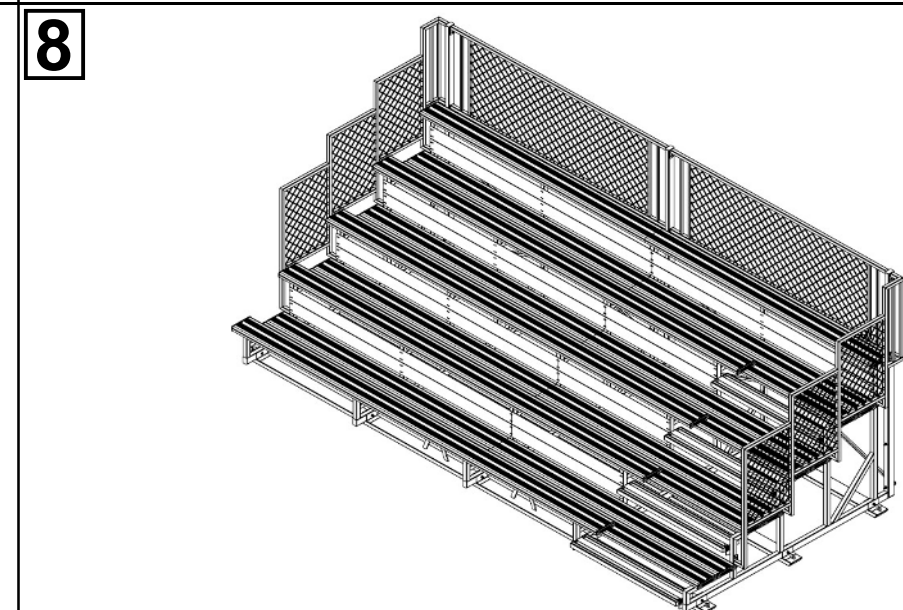

Tighten completely all bolts and nuts with spanners and appropriate tools.  
**The grandstand is now ready to be used.**