

ASSEMBLY INSTRUCTION

Thank You

FOR CHOOSING FELTON INDUSTRIES

TIP 'N' ROLL GRANDSTAND
[Code No: FELTR32]



"This product has been manufactured in Australia to the highest quality standard, guaranteeing proven quality, durability and low maintenance"



☎ 1800 22 00 55

🖨 1800 05 91 58

✉ sales@felton.net.au

🌐 www.felton.net.au



Felton Industries Pty Ltd | ABN: 17 130 687 240



WARNING: This assembly required two or more people as lifting is involved. Please ensure bolts and nuts are only finger-tightened throughout assembly for flexibility in lining up components. Bolt and nuts should be securely tightened in place when instructed to do so. Please check all components are included before proceeding with the assembly

ITEM	DESCRIPTION	Qty
1	FELTR32_MAIN FRAME	2
2	FELTR32_TIER PLANK L2000	5
3	AS-NZS 2465 Bolt - 1/4" x 1"	56
4	AS-NZS NYLON Nut - 1/4"	56
5	Caster Dia125mm	2
6	Caster Dia125mm with Brake	2

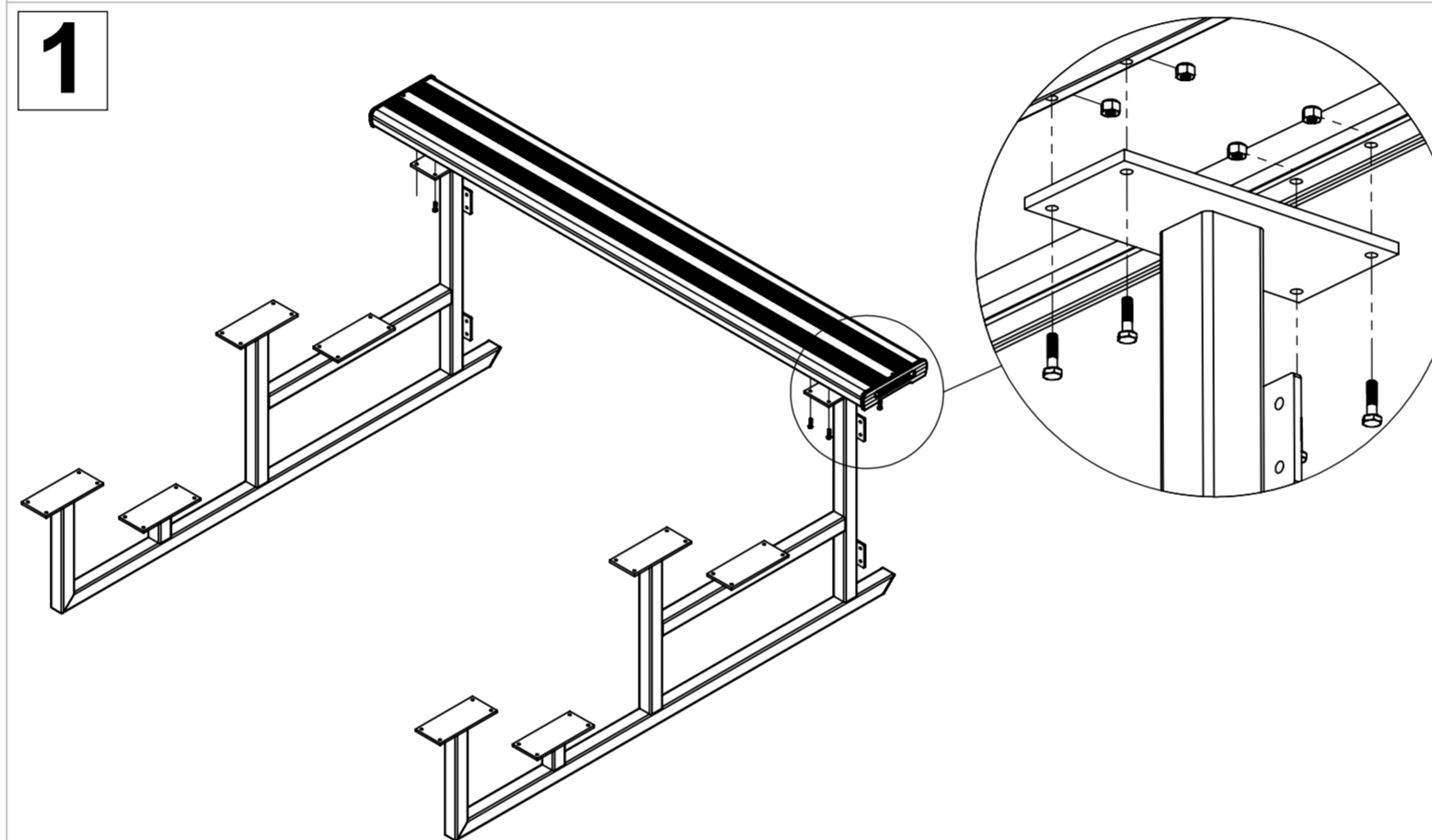
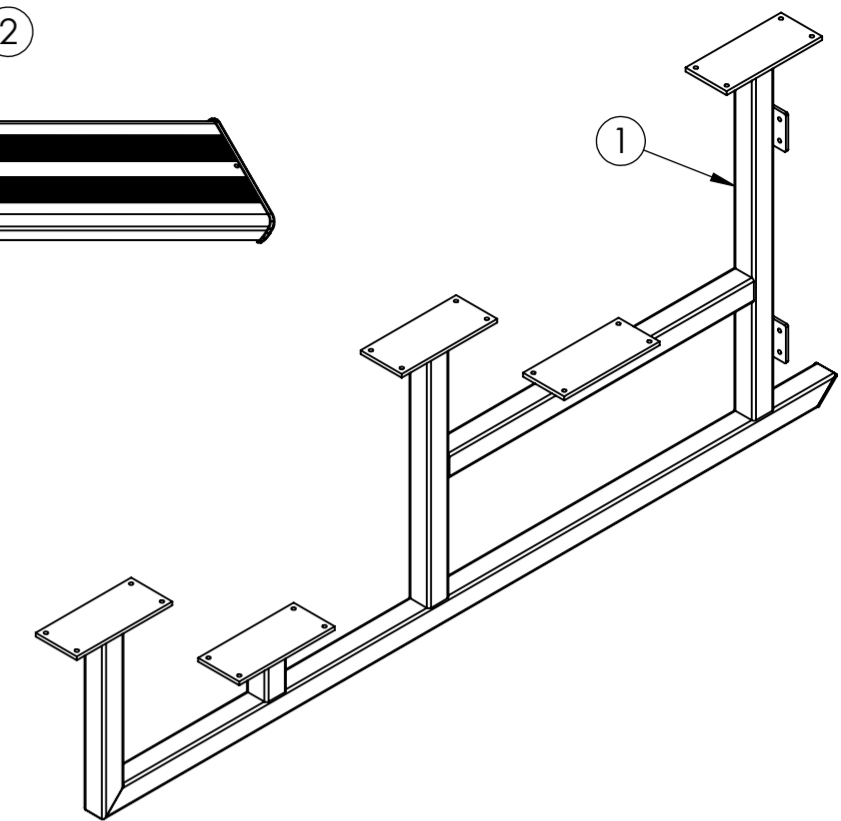
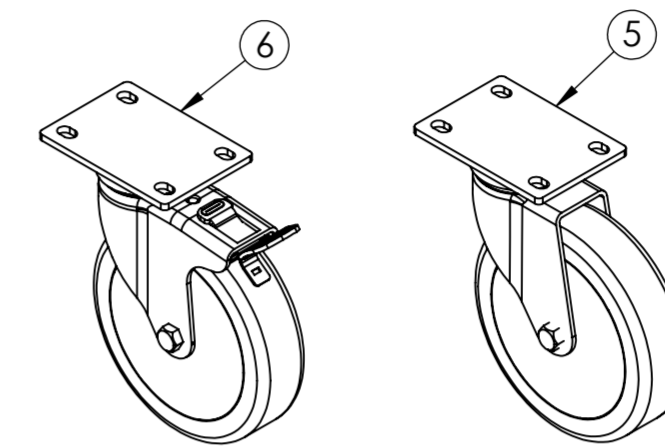
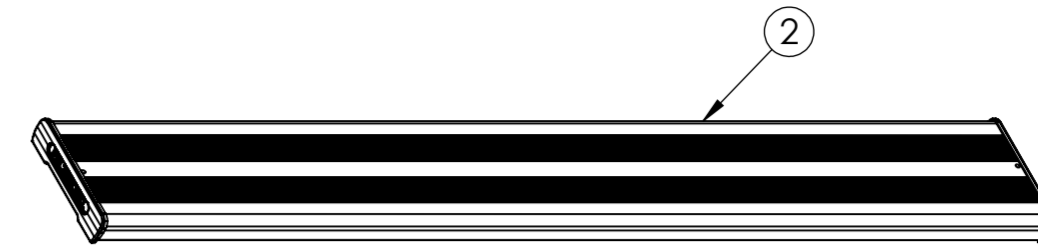
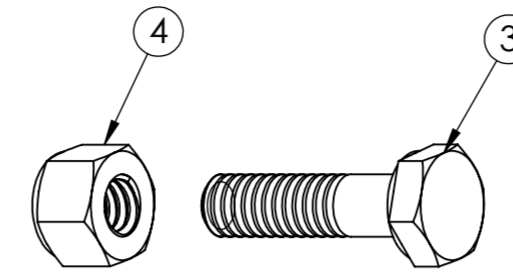

Attach one plank (2) to two base frames (1) at the top position by using bolts (3) and nuts (4) as illustrated.

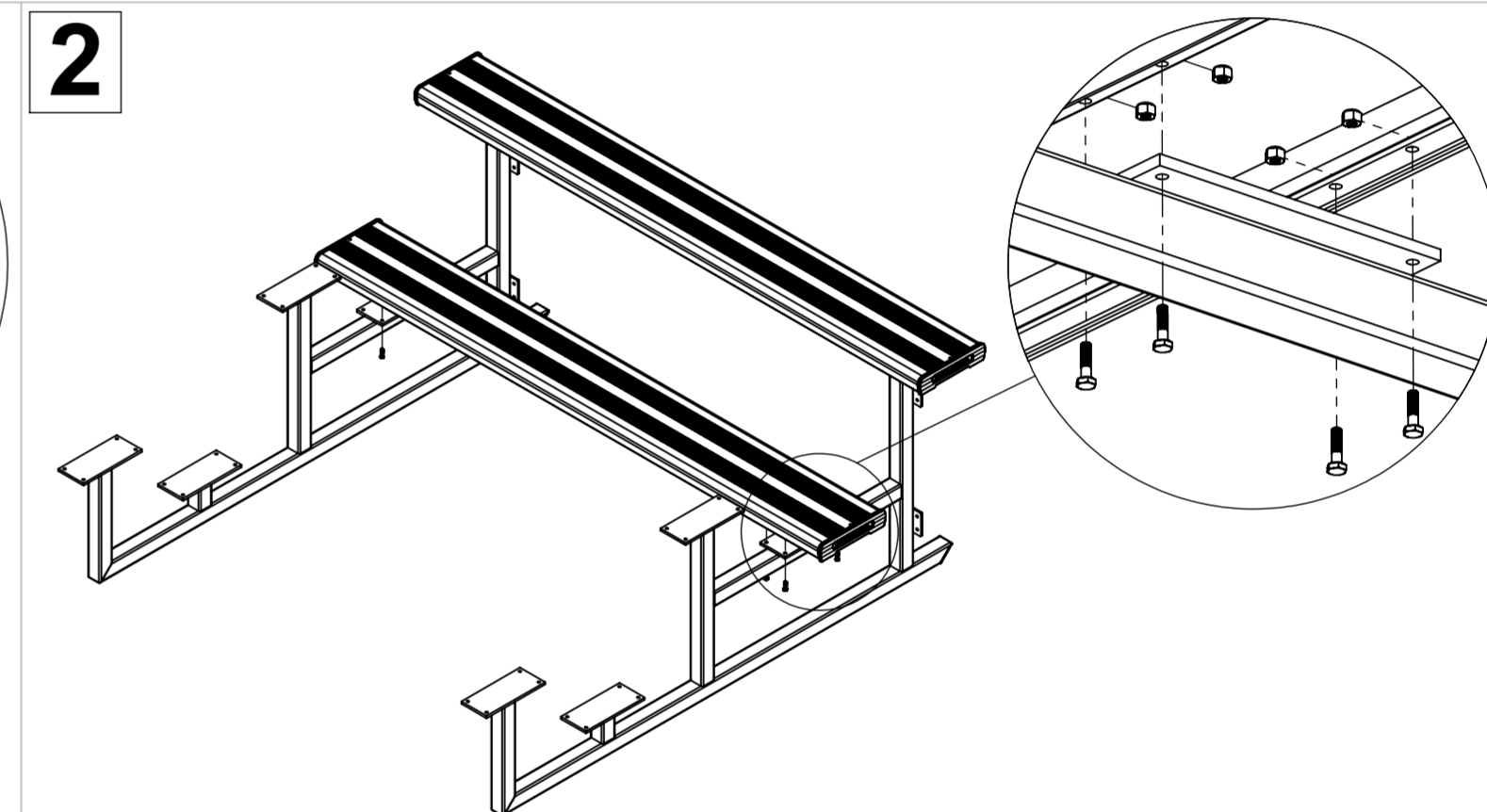

Attach another plank (2) to two base frames (1) at the lower position by using bolts (3) and nuts (4) as illustrated.

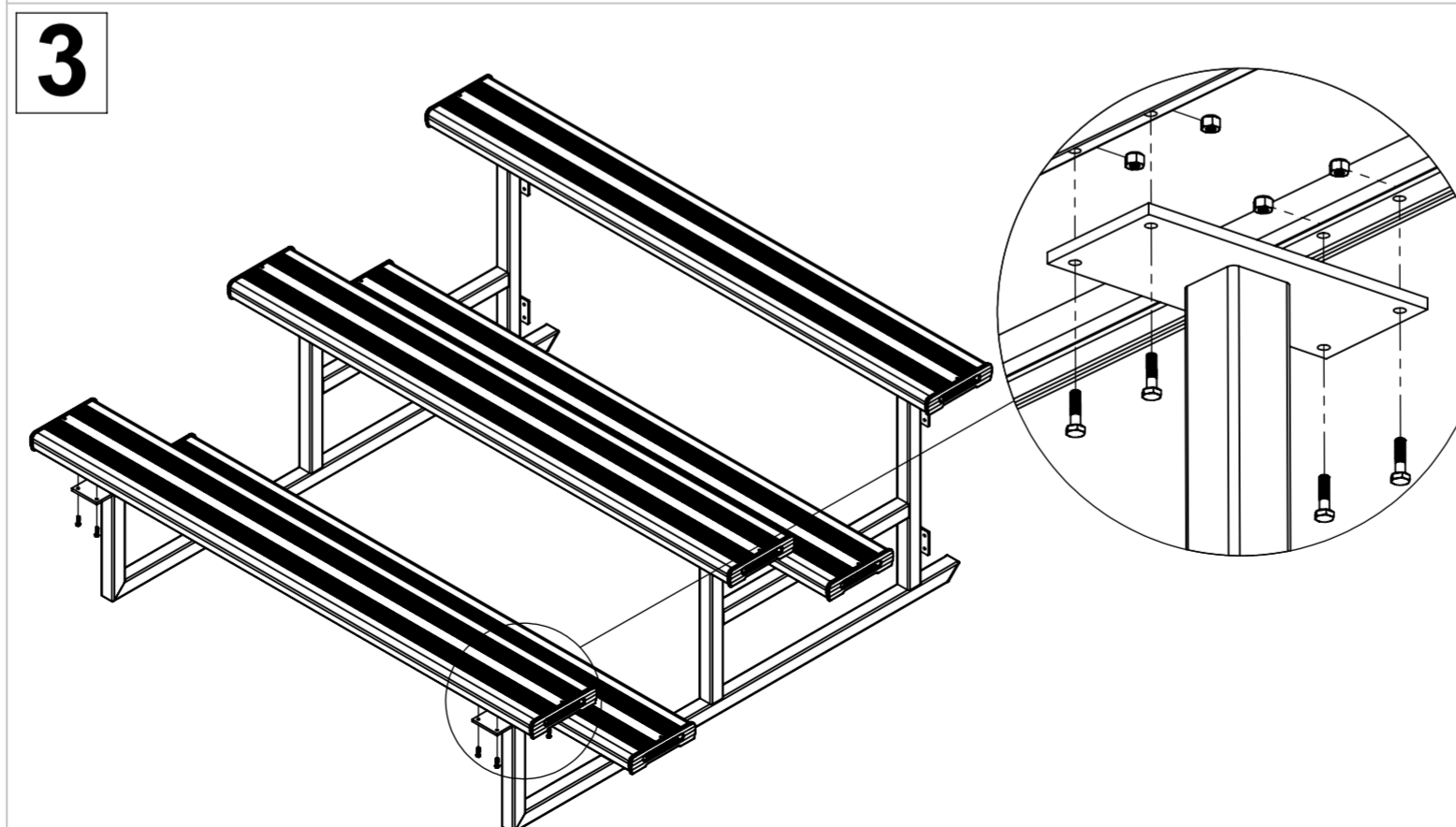

Repeat the previous steps with three remaining planks (2) as illustrated.

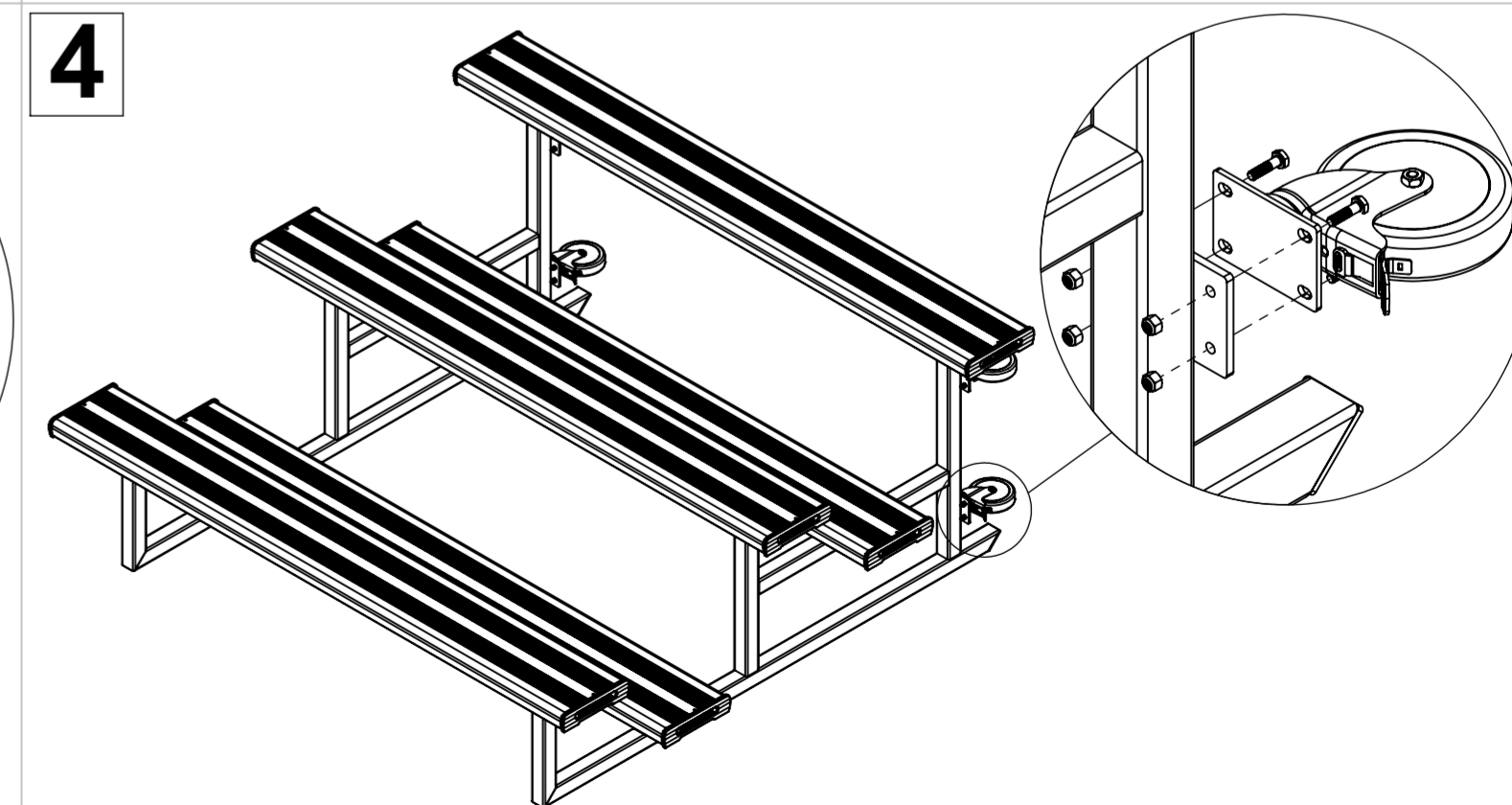

Attach four casters (5) and (6) to four fixing plates at the back of base frames (1) by using bolts (3) and nuts (4) as illustrated. Ensure that each base frame has one brake caster (6)