

ASSEMBLY INSTRUCTION

Thank You

FOR CHOOSING FELTON INDUSTRIES

SUNSAFE SELECT GRANDSTAND
[Code No: SELG4T4R]



"This product has been manufactured in Australia to the highest quality standard, guaranteeing proven quality, durability and low maintenance"



☎ 1800 22 00 55

📄 1800 05 91 58

✉ sales@felton.net.au

🌐 www.felton.net.au



Felton Industries Pty Ltd | ABN: 17 130 687 240



WARNING: This assembly required two or more people as lifting is involved. Please ensure bolts and nuts are only finger-tightened throughout assembly for flexibility in lining up components. Bolt and nuts should be securely tightened in place when instructed to do so. Please check all components are included before proceeding with the assembly

ITEM	DESCRIPTION	Qty
1	SELG4T4R_BASE FRAME ASM	4
2	SELG4T4R_TIER PLANK L4000 ASM	6
3	SELG4T4R_4th SEAT PLANK L4000 ASM	1
4	SELG4T4R_BACKREST PLANK L4000 ASM	1
5	SELG4T4R_AL FLAT BAR 80x6xL4000	1
6	SELG4T4R_AL FLAT BAR 50x4xL1390	6
7	AS-NZS 2465 Bolt - 1/4" x 1"	120
8	AS-NZS NYLON Nut - 1/4"	120
9	AS 1112 Bolt - 3/8" x 1"	4
10	AS 1112 Nut - 3/8"	4
11	AS-NZS 2465 Bolt - 1/2" x 3.5"	32
12	AS-FLAT WASHER - 1/2"	96
13	AS-NZS NYLON Nut - 1/2"	48

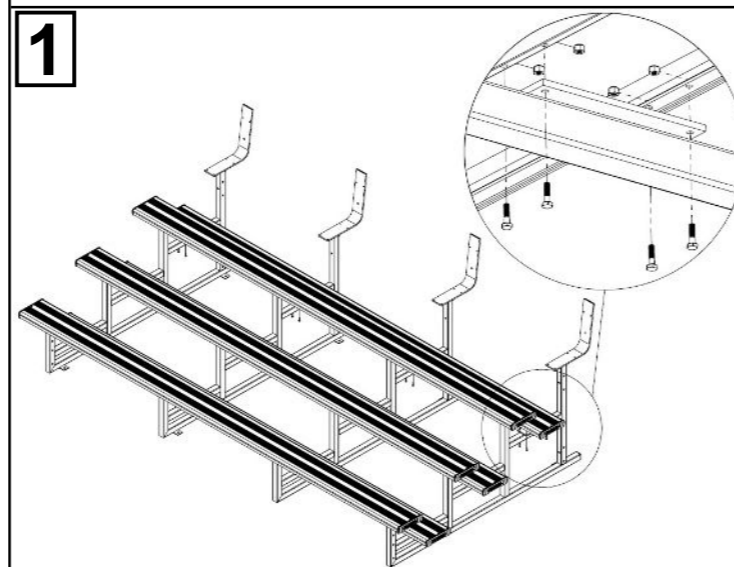
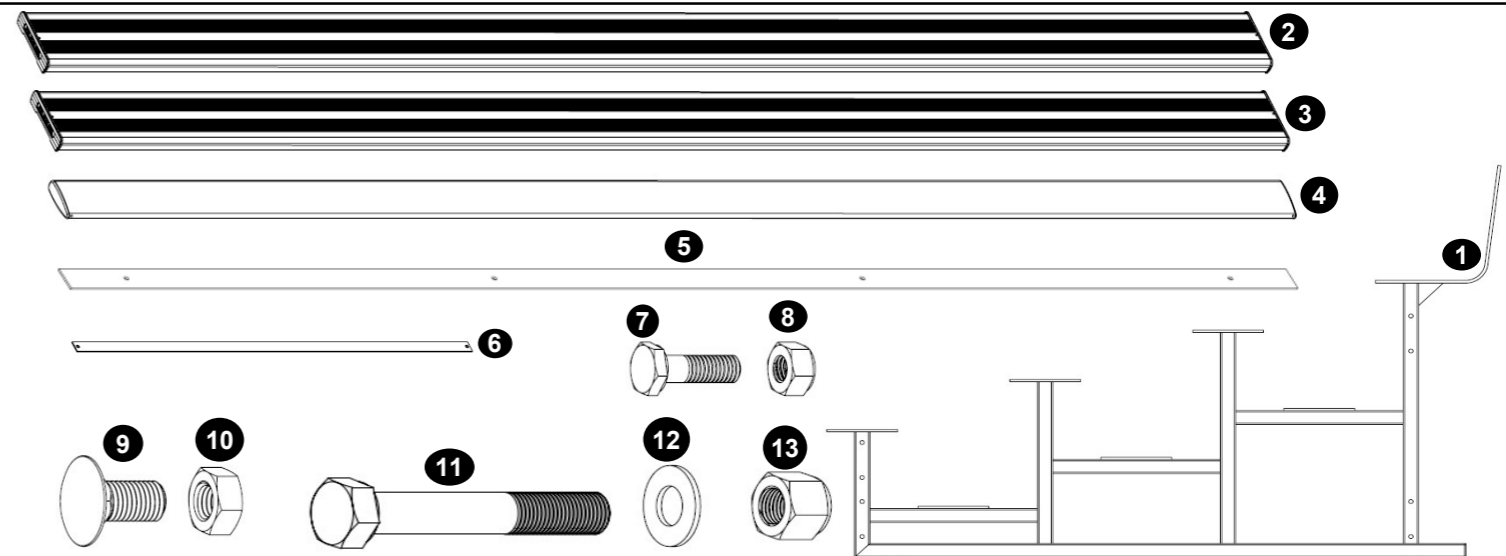

Attach six planks ② to four base frames ① to create tread and seat platforms by using bolts ⑦ and nuts ⑧. **Note that all fixing lugs on base frames face inwards.**

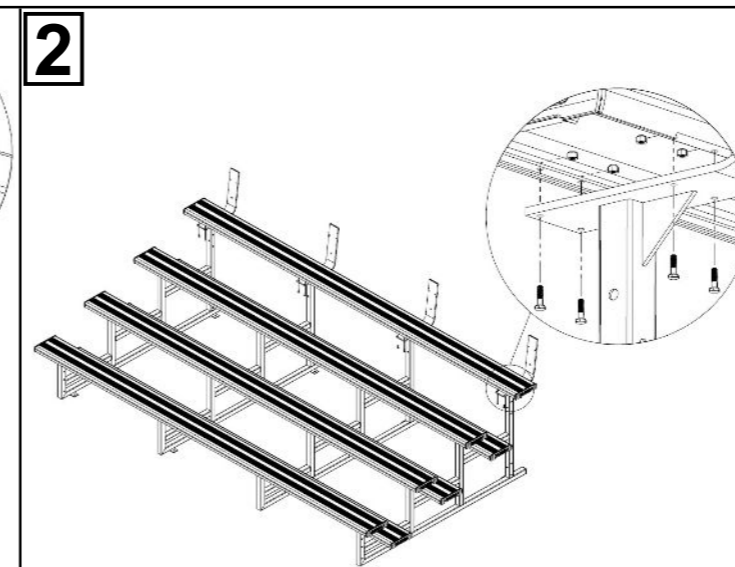

Attach 4th seat plank ③ (with notch cut beneath) to the assembly in step 1 by using bolts ⑦ and nuts ⑧ as illustrated.

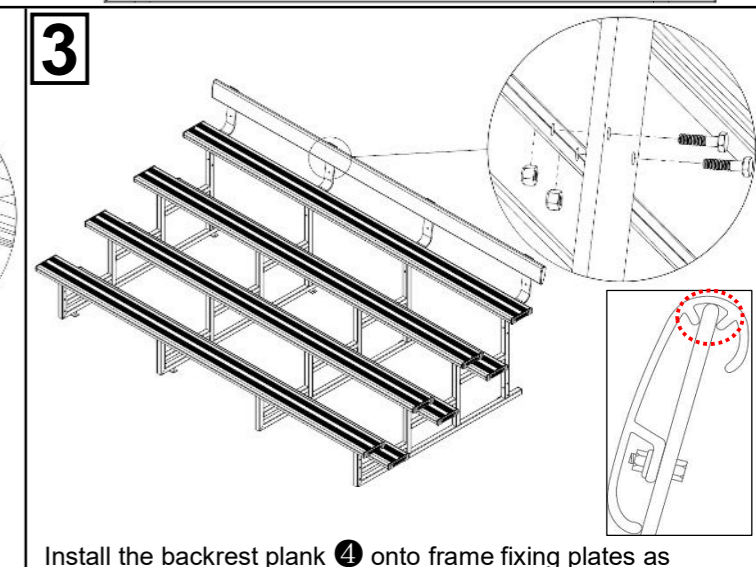

Install the backrest plank ④ onto frame fixing plates as illustrated. Fasten the backrest plank ④ with hexagonal bolts ⑦ and nuts ⑧. Ensure the fixing plates are installed in the right place on backrest plank.

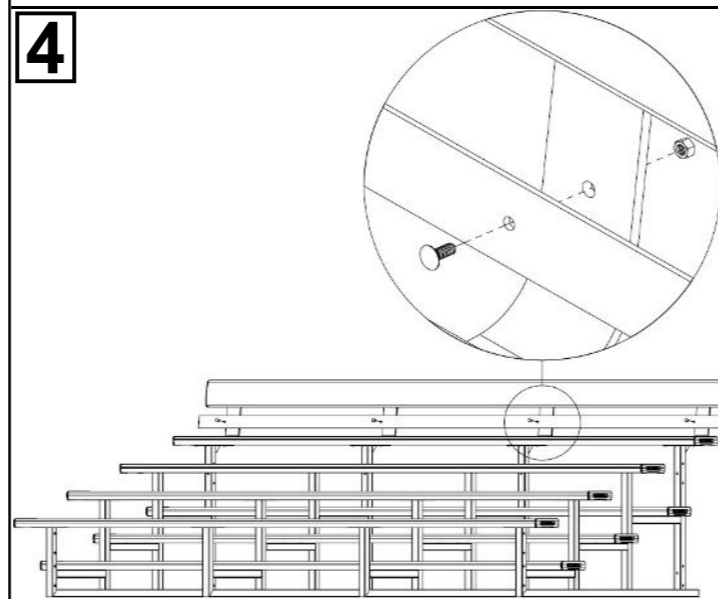

Attach the long flat bar ⑤ to fixing plates by using bolts ⑨ and nuts ⑩ as illustrated.

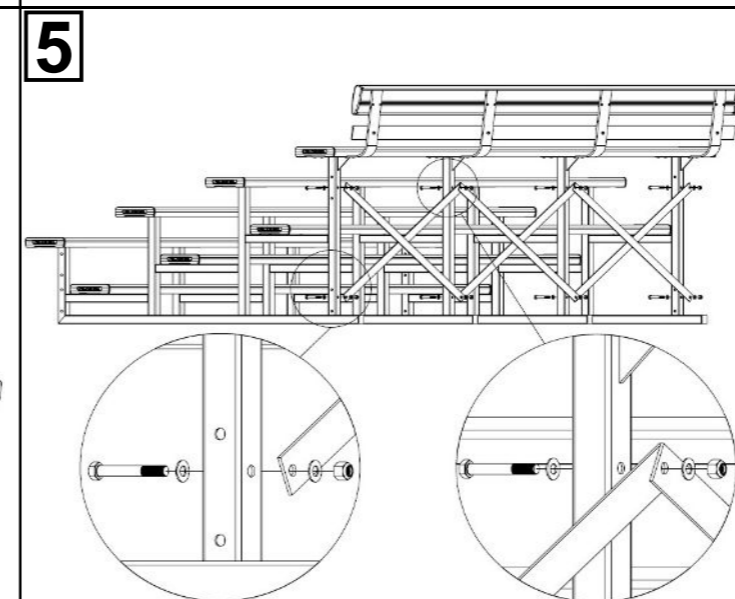

Attach six flat bars ⑥ to the back of base frames ① by using bolts ⑪, washers ⑫ and nuts ⑬ as illustrated.

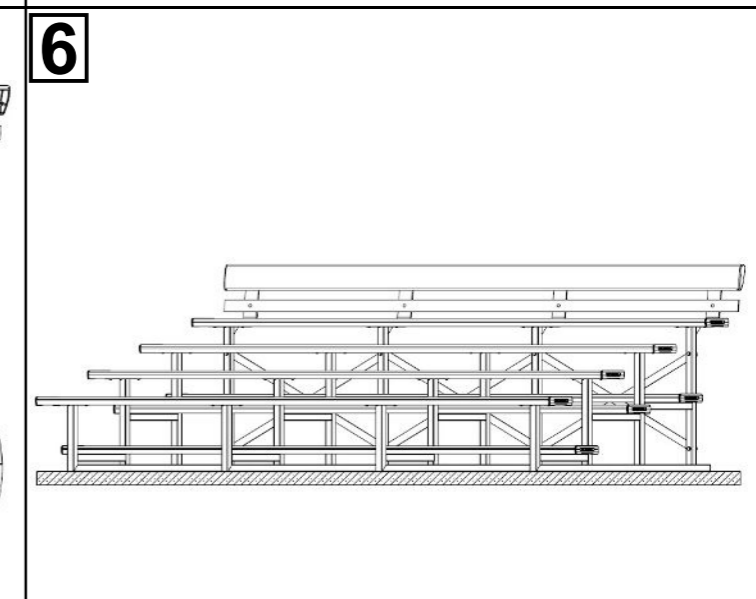

Tighten all hexagonal head bolts with spanners and appropriate tools. Then completely tighten the M12 dynabolts to attach the whole assembly firmly to the ground.

ASSEMBLY INSTRUCTION

Thank You

FOR CHOOSING FELTON INDUSTRIES

SUNSAFE SELECT GRANDSTAND
[Code No: SELG4T4R]



"This product has been manufactured in Australia to the highest quality standard, guaranteeing proven quality, durability and low maintenance"



1800 22 00 55

1800 05 91 58

sales@felton.net.au

www.felton.net.au



Felton Industries Pty Ltd | ABN: 17 130 687 240



WARNING: This assembly required two or more people as lifting is involved. Please ensure bolts and nuts are only finger-tightened throughout assembly for flexibility in lining up components. Bolt and nuts should be securely tightened in place when instructed to do so. Please check all components are included before proceeding with the assembly

ITEM	DESCRIPTION	Qty
14	SELG4T4R_ROOF BASE FRAME FRONT ASM	2
15	SELG4T4R_ROOF BASE FRAME REAR ASM	2
16	SELG4T4R_LEFT DIAGONAL BAR ASM	1
17	SELG4T4R_RIGHT DIAGONAL BAR ASM	1
18	SELG4T4R_SUPPORT BAR ASM	2
19	SELG4T4R_ROOF CONNECTION BAR ASM	2
20	SELG4T4R_ROOF CROSS BAR ASM	4
21	CORRUGATED CUSTOM Orb .42	5
22	AS-NZS 2465 Bolt - 1/2" x 4.5"	12
23	AS-NZS 2465 Bolt - 1/2" x 6"	4
24	AS-Screw-ST5.5x39	88

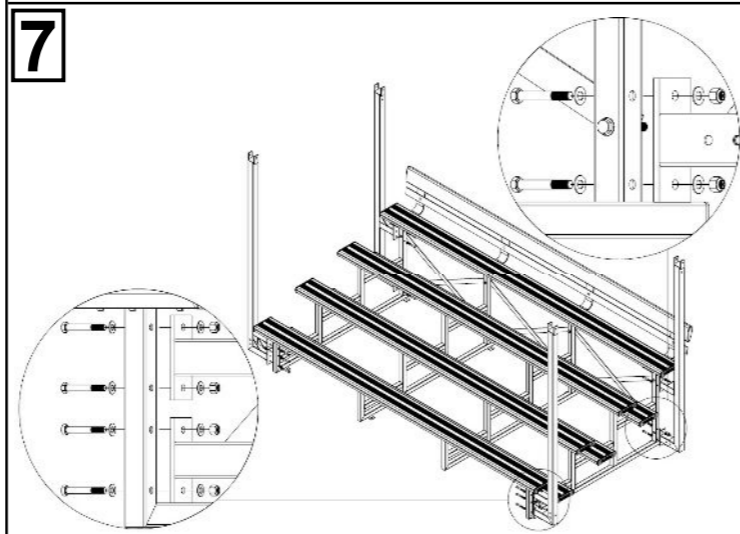
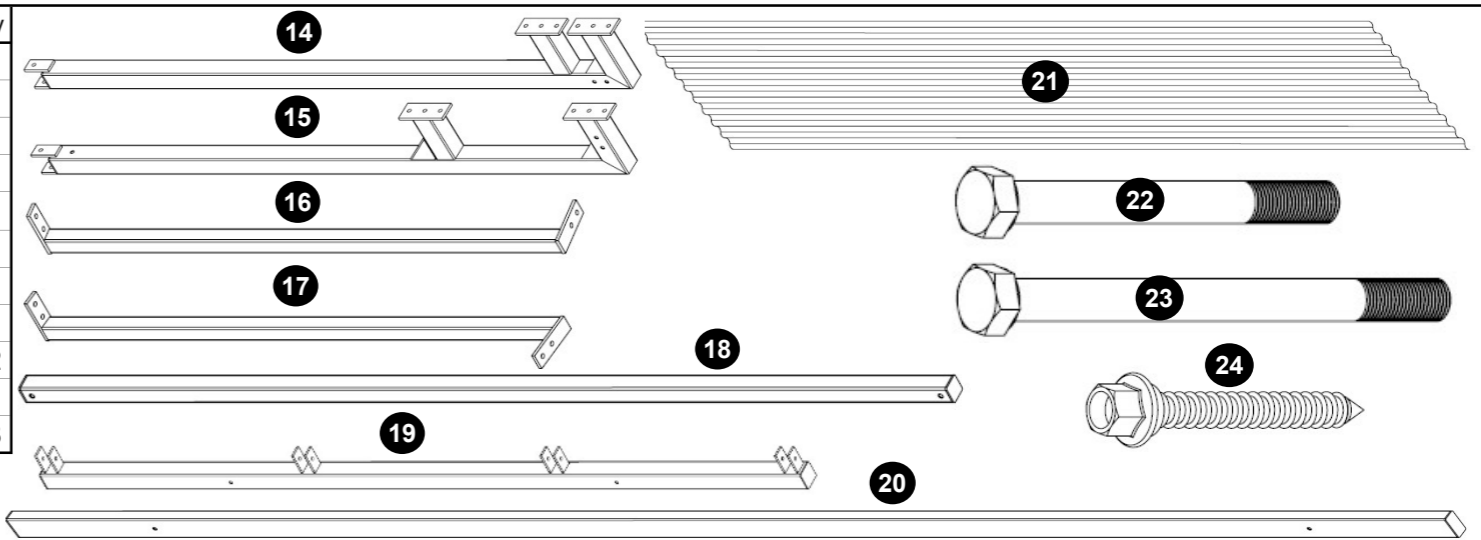

Attach two front roof frames **14** and two rear roof frames **15** to the assembly in step 6 by using bolts **11**, washers **12** and nuts **13** as illustrated.

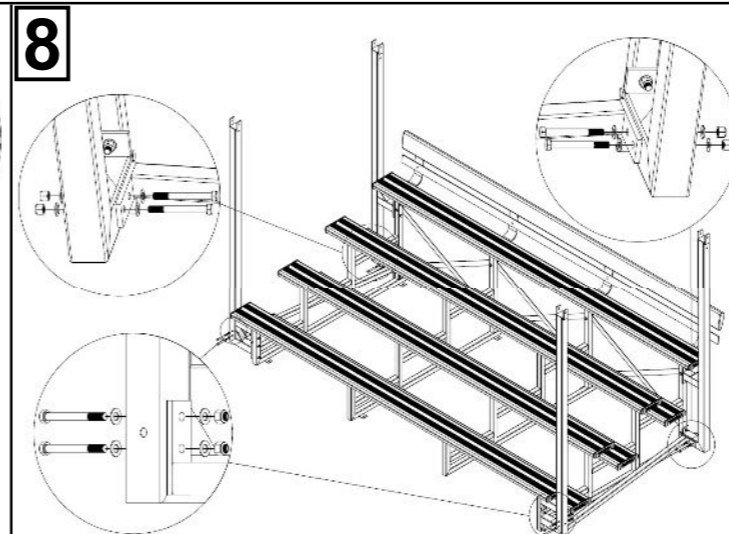

Attach left diagonal bar **16** and right diagonal bar **17** to the assembly in step 7 by using bolts **22**, washers **12** and nuts **13** as illustrated.

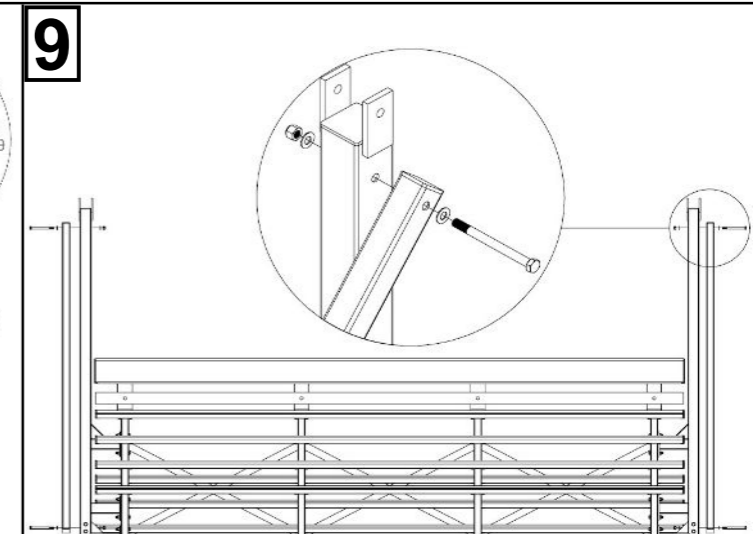

Attach two support bars **18** to the assembly in step 12 by using bolts **23**, washers **12** and nuts **13** as illustrated.

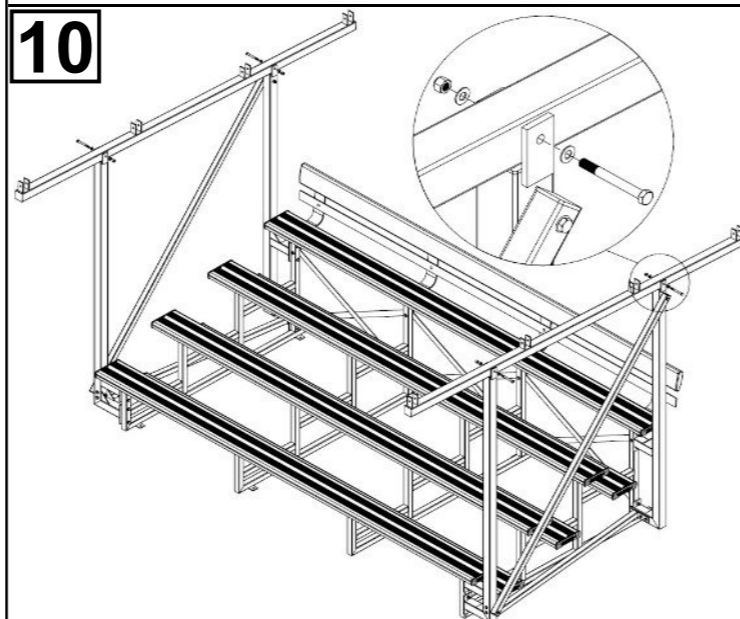

Attach two connection bars **19** to assembly in step 9 by using bolts **22**, washers **12** and nuts **13** as illustrated.

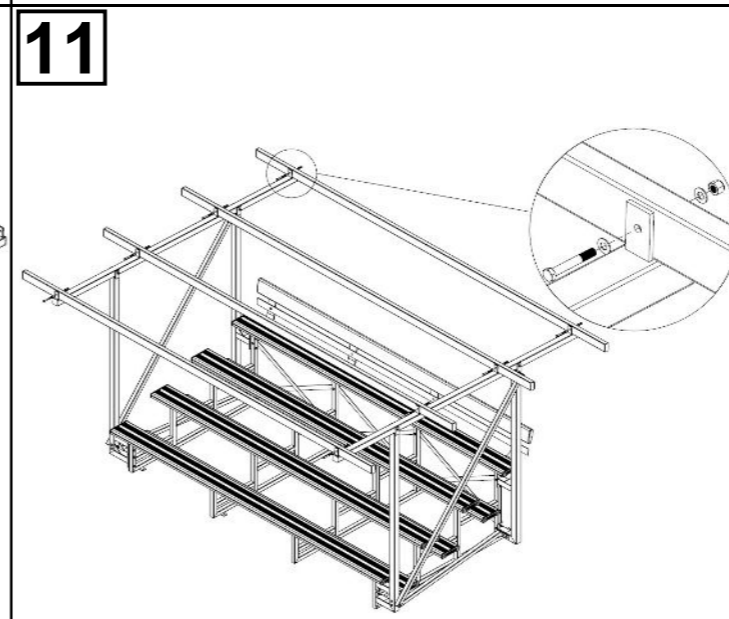

Attach four cross bars **20** to the assembly in step 10 by using bolts **11**, washers **12** and nuts **13** as illustrated. Tighten all hexagonal head bolts with spanners and appropriate tools before moving on to the final step.

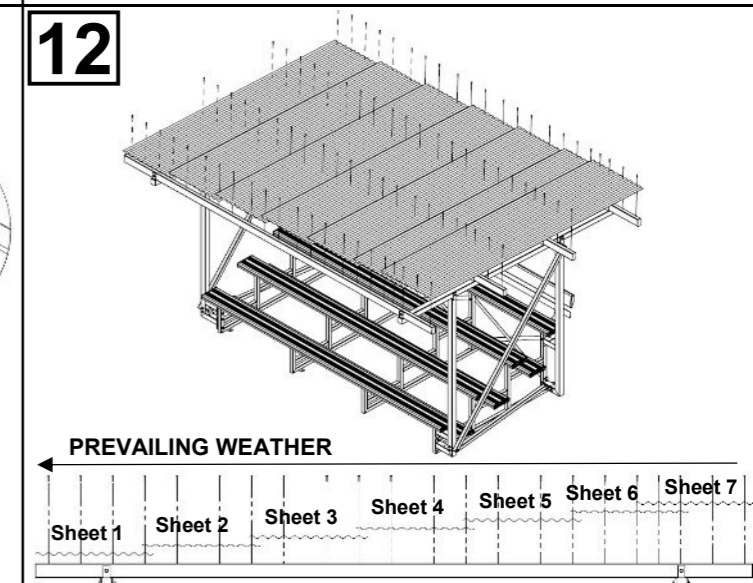

Fasten seven corrugated roofs **21** to the assembly in step 11 by screws **24**. Ensure that the roofs' overlapping position and screws' position are conformed with the illustration in the picture. Note that the valleys of sheets should be turned-down at lower ends, and turned-up at upper ends as recommendation from manufacturer. **The grandstand is now ready to be used!**