

ASSEMBLY INSTRUCTION

Thank You

FOR CHOOSING FELTON INDUSTRIES

WIRIMBIRRA WIRIMBIRRA BIN ENCLOSURE
[Code No: TBR240BS]



"This product has been
manufactured in Australia to the
highest quality standard,
guaranteeing proven quality,
durability and low maintenance"



1800 22 00 55 1800 05 91 58
sales@felton.net.au www.felton.net.au



Felton Industries Pty Ltd | ABN: 17 130 687 240



WARNING: This assembly required two or more people as lifting is involved. Please ensure bolts and nuts are only finger-tightened throughout assembly for flexibility in lining up components. Bolt and nuts should be securely tightened in place when instructed to do so. Please check all components are included before proceeding with the assembly

ITEM	DESCRIPTION	QTY
1	TBR240BS_FRAME LHS	1
2	TBR240BS_FRAME RHS	1
3	TBR240BS_TOP LID	1
4	TBR240BS_HOOD	1
5	TBR240BS_DOOR	1
6	TBR240BS_LIFT OFF HINGE	2
7	TBR240BS_LOCK	1
8	TBR240BS_BUTTON SCREW_ISO 7380 - M6 x 16	16
9	TBR240BS_BUTTON SCREW_ISO 7380 - M5 x 20	4
10	TBR240BS_BUTTON SCREW_ISO 7380 - M5 x 16	4

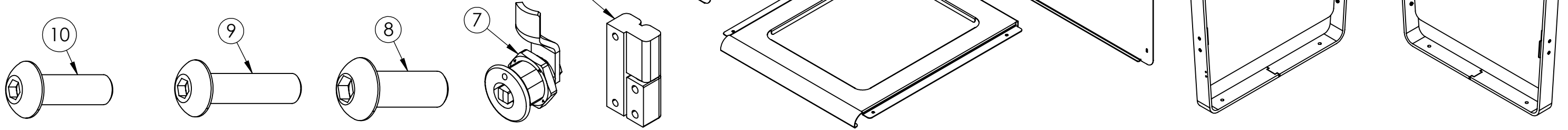

1

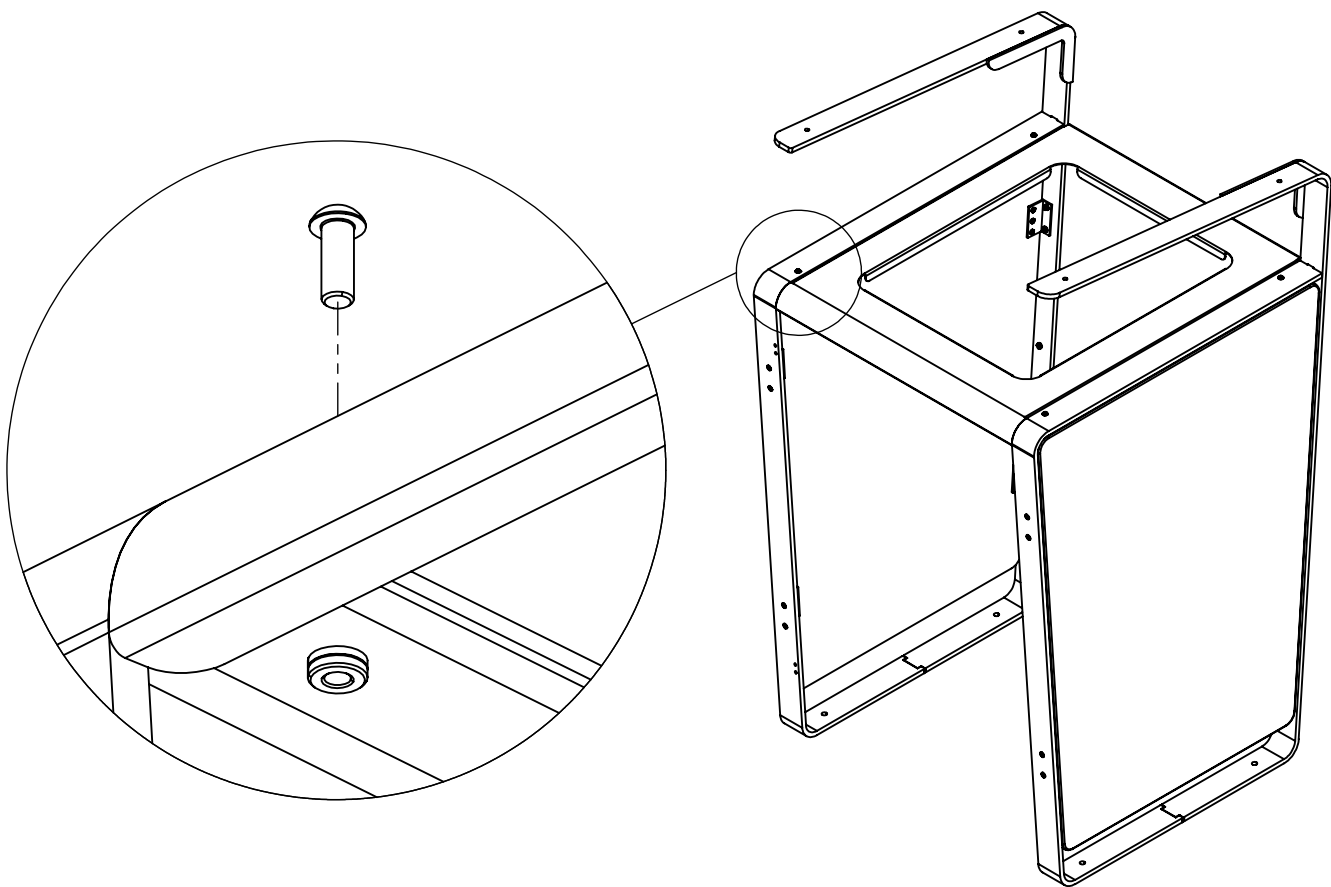

Attach the bin lid (3) to LHS and RHS frame (1 & 2) by using bolt (8) to create a solid assembly as illustrated.

2

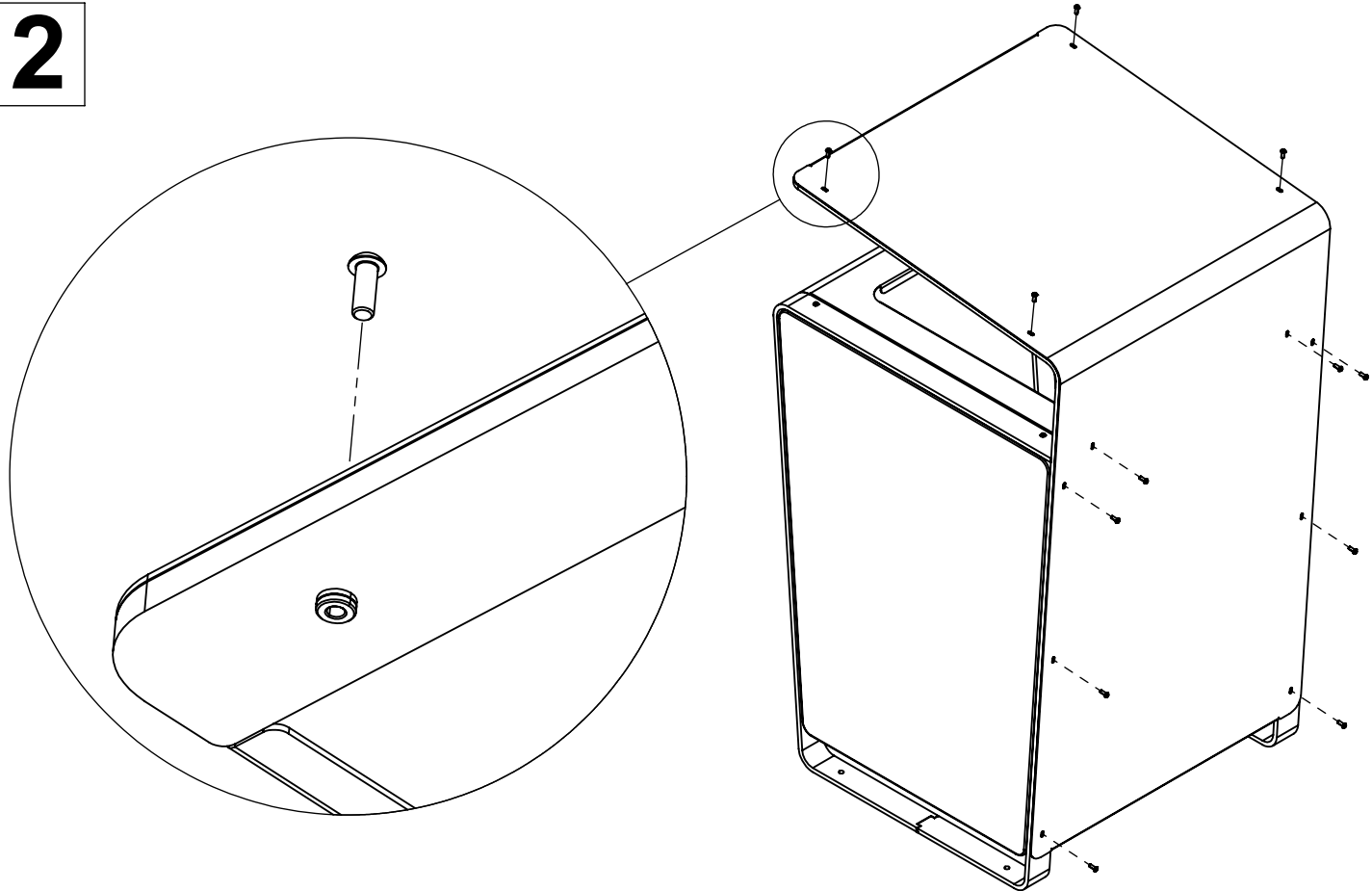

Attach the bin hood (4) to the back of the assembly in step 1 by using bolts (8) as illustrated.

3

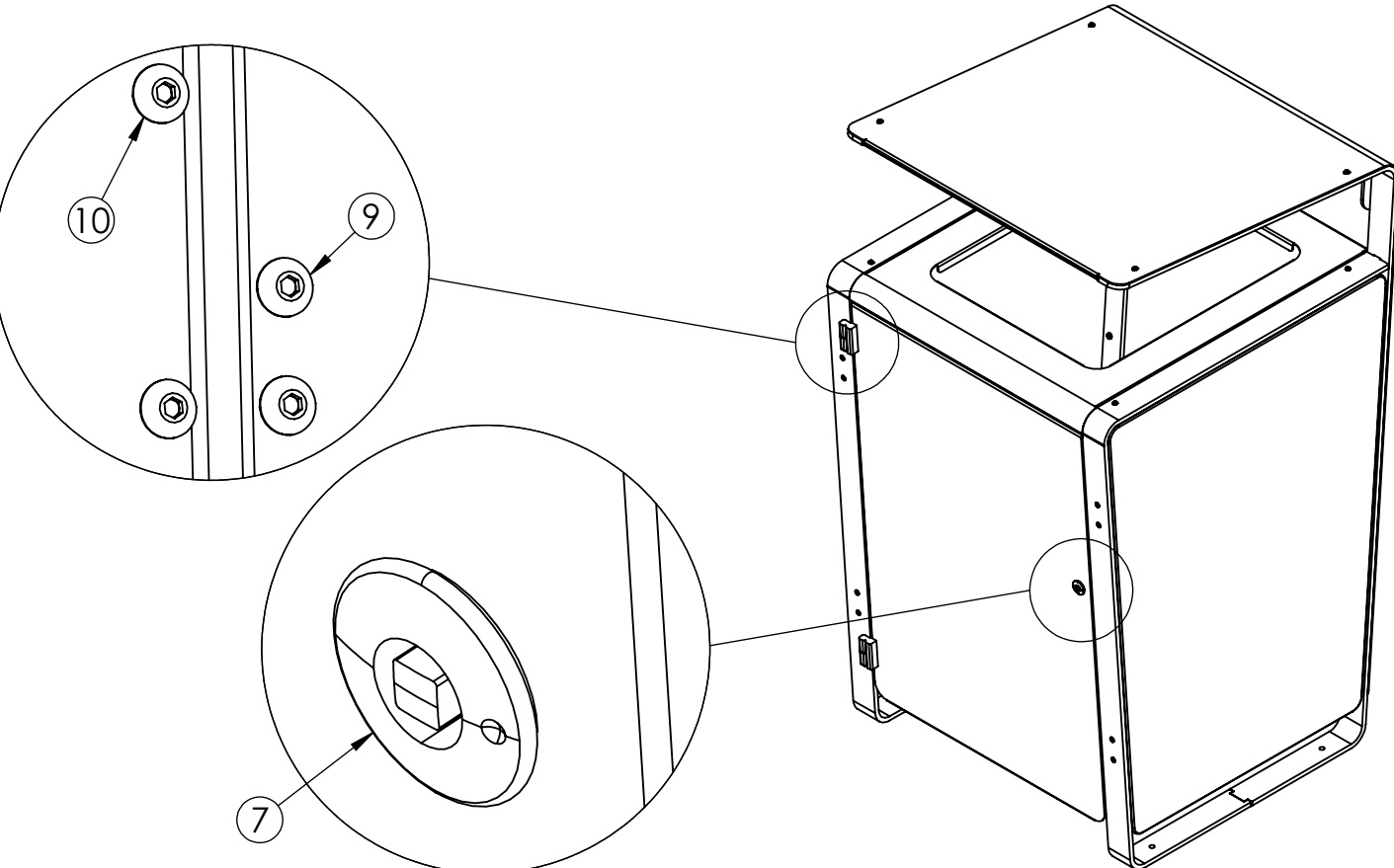

Attach two lift off hinges (6) to the door (5) and the LHS frame (1) by using screw (9 & 10) as illustrated. Then attach the cam lock (7) to the door.

4

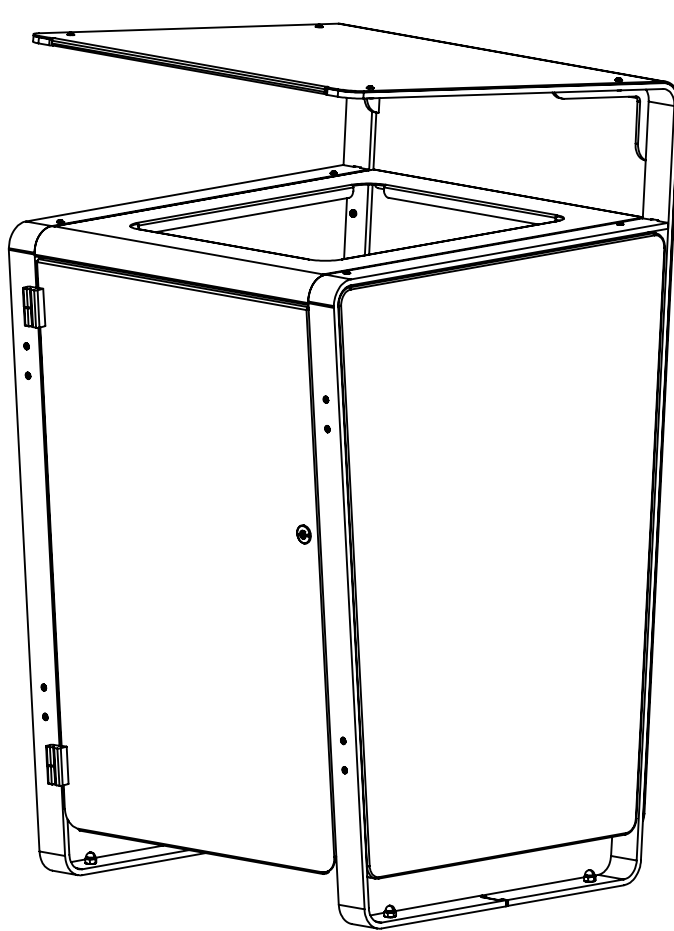

Attach the whole assembly to the ground by using M10 dyna-bolts preferably, on each side frame.